

JOHNSON 

16H 6ZJ00905

**REPOWER
PARTS
LIST
AND
WIRING HARNESS**

**RIO
TINTO**

MINERALS

JOHNSON MACHINERY



Service Information System

Shutdown SIS

[Previous Screen](#)

Product: NO EQUIPMENT SELECTED
 Model: NO EQUIPMENT SELECTED
 Configuration: NO EQUIPMENT SELECTED

16M Motor Grader, Powered By C13 Engine

Media Number - SEBP4108-21 | Publication Date - 01/02/2009 | Date

Updated - 18/02/2009

i03361841

285-0103 COMMON AR
 S/N B9H1-617

ENTIRE GROUP

Ref.	Qty.	NPR Note	Part No.	Part Name
Grp	<input type="text"/>	NPR	285-0103	COMMON AR

INDIVIDUAL PARTS

Ref.	Qty.	NPR Note	Part No.	Req. Qty.	Part Name
<input type="text"/>		NPR Y	249-7319	1	AIR CLEANER GP
<input type="text"/>		Y	251-1202	1	AXLE AR-FRONT
<input type="text"/>		NPR Y	284-5026	1	AXLE GP-REAR
<input type="text"/>		NPR Y	257-8027	1	BATTERY GP (HEAVY DUTY)
<input type="text"/>		NPR Y	257-3466	1	BIT GP-END
<input type="text"/>		NPR Y	249-9170	1	BLADE GP
<input type="text"/>		NPR Y	233-3107	1	CAB AR
<input type="text"/>		NPR Y	6G-1740	1	CHAIN GP-DRIVE (TANDEM)
<input type="text"/>		NPR Y	259-4500	1	CIRCLE GP
<input type="text"/>		NPR Y	288-9614	1	CONTROL GP-DIFFERENTIAL LOCK
<input type="text"/>		Y	249-7363	1	COOLING AR
<input type="text"/>		NPR Y	250-0154	1	COUPLING GP-TORSIONAL
<input type="text"/>		NPR Y	250-0159	1	COVER GP-CONTROL VALVE
<input type="text"/>		NPR Y	283-7764	1	CYLINDER & MTG GP-ARTICULATION
<input type="text"/>		NPR Y	261-2372	1	CYLINDER & MTG GP-BLADE LIFT
<input type="text"/>		NPR Y	260-3646	1	CYLINDER & MTG GP-BLADE TIP
<input type="text"/>		NPR Y	261-2373	1	CYLINDER & MTG GP-CENTERSHIFT
<input type="text"/>		NPR Y	257-6804	1	CYLINDER & MTG GP-SIDESHIFT
<input type="text"/>		NPR Y	257-4930	1	DRAWBAR GP
<input type="text"/>		NPR Y	258-0651	1	DRIVE GP-ACCESSORY
<input type="text"/>		NPR Y	265-6725	1	DRIVE GP-CIRCLE
<input type="text"/>		NPR Y	250-0160	1	ENCLOSURE GP-ENGINE

	NPR Y	<u>286-7322</u>	1	FILLER GP-POWER TRAIN OIL
	NPR Y	<u>291-6299</u>	1	FILTER GP-ENGINE OIL
	NPR Y	<u>286-1301</u>	1	FRAME GP-FRONT
	NPR Y	<u>284-6068</u>	1	FRAME GP-REAR
	NPR Y	<u>250-2283</u>	1	HITCH GP-ARTICULATING
	NPR Y	<u>265-6710</u>	1	LIFT GP-BLADE
	NPR Y	<u>249-7322</u>	1	LINES GP-AIR
	NPR Y	<u>283-7769</u>	1	LINES GP-AIR CONDITIONER
	NPR Y	<u>249-6531</u>	1	LINES GP-CENTERSHIFT LOCK
	NPR Y	<u>277-3628</u>	1	LINES GP-FUEL (FAST FILL SYSTEM)
	NPR Y	<u>283-7768</u>	1	LINES GP-HEATER
	NPR Y	<u>283-7734</u>	1	LINES GP-HYDRAULIC FAN
	NPR Y	<u>249-6548</u>	1	LINES GP-POWER TAKE-OFF
	Y	<u>283-7735</u>	1	LINES GP-SECONDARY STEERING
	NPR Y	<u>283-7767</u>	1	LINES GP-SECONDARY STEERING (DRIVE PUMP)
	NPR Y	<u>283-7766</u>	1	LINES GP-SERVICE BRAKE
	NPR Y	<u>249-6550</u>	1	LINES GP-STEERING
	NPR Y	<u>288-9615</u>	1	LINES GP-TRANSMISSION OIL
	NPR Y	<u>249-7325</u>	1	LINES GP-WATER
	NPR Y	<u>249-6537</u>	1	LOCK GP-CENTERSHIFT
	NPR Y	<u>284-5038</u>	1	MOUNTING GP-AXLE (REAR)
	NPR Y	<u>249-7326</u>	1	MOUNTING GP-ENGINE & XMSN
	NPR Y	<u>249-6554</u>	1	MOUNTING GP-VALVE (IMPLEMENT, STEERING)
	NPR Y	<u>250-8213</u>	1	MOUNTING GP-WHEEL
	NPR Y	<u>249-7327</u>	1	MUFFLER GP
	NPR Y	<u>292-9680</u>	1	OIL CHANGE GP-HIGH SPEED (ENGINE)
	NPR Y	<u>249-6534</u>	1	PUMP & MTG GP-HYDRAULIC FAN
	NPR Y	<u>249-6532</u>	1	PUMP & MTG GP-PISTON (IMPLEMENT, STEERING)
	NPR Y	<u>283-7774</u>	1	PUMP & MTG GP-SECONDARY STEER (ELECTRIC DRIVE)
	NPR Y	<u>249-7324</u>	1	PUMP GP-FUEL PRIMING
	NPR Y	<u>250-0162</u>	1	SERVICE CENTER AR
	NPR Y	<u>250-8212</u>	1	SHAFT GP-DRIVE
	NPR Y	<u>249-7310</u>	1	STARTING AID GP-ETHER
	NPR Y	<u>273-3001</u>	1	SUPPORT GP-FUEL TANK
	NPR Y	<u>285-0604</u>	1	TANDEM & COVER GP
	NPR Y	<u>257-7500</u>	1	TANK GP-COOLANT
	NPR Y	<u>250-0161</u>	1	TANK GP-FUEL
	NPR Y	<u>253-8407</u>	1	TRANSMISSION AR

<input type="checkbox"/>	NPR Y	<u>262-7898</u>	1	WALKWAY GP (TANDEM) S/N B9H1-580
<input type="checkbox"/>	NPR Y	<u>329-8820</u>	1	WALKWAY GP (TANDEM) S/N B9H581-617
<input type="checkbox"/>	NPR Y	<u>257-7224</u>	1	WARNING GP-BACKUP
<input type="checkbox"/>	Y	<u>285-0609</u>	1	WHEEL AR
<input type="checkbox"/>	NPR Y	<u>250-0890</u>	1	WIRING GP-FRONT
<input type="checkbox"/>	NPR Y	<u>260-1870</u>	1	WIRING GP-REAR
<input type="checkbox"/>	NPR Y	<u>260-1871</u>	1	WIRING GP-REAR (CIRCUIT BREAKER PANEL)
<input type="checkbox"/>	NPR Y	<u>260-1872</u>	1	WIRING GP-SECONDARY STEERING
<input type="checkbox"/>	NPR	6V-1970	1	LITERATURE GP
<input type="checkbox"/>	NPR	5P-7958	1	SLEEVE-CABLE SPLICE
<input type="checkbox"/>	NPR	5P-8500	2	KEY

Key:

Y - SEPARATE ILLUSTRATION

SMCS Codes		
7000		

JOHNSON MACHINERY



Service Information System

Shutdown SIS

[Previous Screen](#)

← Product: NO EQUIPMENT SELECTED
 Model: NO EQUIPMENT SELECTED
 Configuration: NO EQUIPMENT SELECTED

16M Motor Grader, Powered By C13 Engine

Media Number - SEBP4108-21 | Publication Date - 01/02/2009 | Date
 Updated - 18/02/2009

i02817349

227-5359 ENGINE AR-COMplete
S/N MHX1214-UP
CANNOT BE USED WITH 231-0876
AN ATTACHMENT

ENTIRE GROUP

Ref.	Qty.	NPR Note	Part No.	Part Name
Grp	<input checked="" type="checkbox"/>	NPR	227-5359	ENGINE AR-COMplete

INDIVIDUAL PARTS

Ref.	Qty.	NPR Note	Part No.	Req. Qty.	Part Name
<input type="checkbox"/>		NPR Y	<u>247-9665</u>	1	BASE GP-OIL FILTER
<input type="checkbox"/>		NPR Y	<u>267-0008</u>	1	BREATHER GP S/N MHX1214-2151
<input type="checkbox"/>		NPR Y	<u>267-0007</u>	1	BREATHER GP S/N MHX2152-Up
<input type="checkbox"/>		NPR Y	<u>241-7601</u>	1	CONNECTION GP-ELECTRICAL
<input type="checkbox"/>		NPR Y	<u>233-6191</u>	1	CONTROL & MTG GP-ENGINE ELEK
<input type="checkbox"/>		NPR Y	<u>231-0152</u>	1	COOLER GP-ENGINE OIL
<input type="checkbox"/>		NPR Y	<u>240-5403</u>	1	COOLER GP-TRANSMISSION OIL
<input type="checkbox"/>		NPR Y	<u>220-6390</u>	1	COVER GP-FLYWHEEL HOUSING S/N MHX2761-Up
<input type="checkbox"/>		NPR Y	<u>136-4307</u>	1	COVER GP-FRONT HOUSING
<input type="checkbox"/>		NPR Y	<u>227-2574</u>	1	COVER GP-FRONT HOUSING
<input type="checkbox"/>		NPR Y	<u>117-2786</u>	1	COVER GP-OIL FILTER BASE (ENGINE)
<input type="checkbox"/>		NPR Y	<u>229-2614</u>	1	COVER GP-VALVE MECHANISM
<input type="checkbox"/>		NPR Y	<u>117-2766</u>	1	DAMPER GP
<input type="checkbox"/>		NPR Y	<u>260-1406</u>	1	DRIVE GP-ACCESSORY
<input type="checkbox"/>		NPR Y	<u>267-0009</u>	1	ENGINE AR-CORE S/N MHX1214-3604
<input type="checkbox"/>		NPR Y	<u>286-5804</u>	1	ENGINE AR-CORE S/N MHX3605-3944
<input type="checkbox"/>		NPR Y	<u>301-2265</u>	1	ENGINE AR-CORE

				S/N MHX3945-Up
	NPR	Y	<u>117-2771</u>	1 FASTENER GP-DAMPER & PULLEY
	NPR	Y	<u>219-7440</u>	1 MOUNTING GP-FAN DRIVE
	NPR	Y	<u>244-8676</u>	1 FILLER GP-ENGINE OIL S/N MHX1214-3604
	NPR	Y	<u>231-0151</u>	1 FILLER GP-ENGINE OIL S/N MHX3605-Up
		Y	<u>262-0925</u>	1 FILTER GP-ENGINE OIL S/N MHX1214-2151
	NPR	Y	<u>231-3492</u>	1 FILTER GP-ENGINE OIL S/N MHX2152-Up
	NPR	Y	<u>254-4998</u>	1 FILTER GP-FUEL
	NPR	Y	<u>252-6185</u>	1 FLYWHEEL GP
	NPR	Y	<u>258-4484</u>	1 FUMES DISPOSAL GP
	NPR	Y	<u>262-0596</u>	1 GAUGE GP-OIL LEVEL (DIPSTICK) (ENGINE)
	NPR	Y	<u>277-5425</u>	1 GEAR GP-REAR
	NPR	Y	<u>277-4435</u>	1 HOUSING GP-FLYWHEEL
	NPR	Y	<u>224-0880</u>	1 LIFTING GP-ENGINE
	NPR	Y	<u>268-6686</u>	1 LINES GP-AIR
		Y	<u>254-4999</u>	1 LINES GP-FUEL S/N MHX1214-2151
	NPR	Y	<u>289-4112</u>	1 LINES GP-FUEL S/N MHX2152-Up
	NPR	Y	<u>224-8170</u>	1 LINES GP-TURBOCHARGER OIL
	NPR	Y	<u>243-1667</u>	1 LINES GP-WATER (SINGLE THERMOSTAT)
	NPR	Y	<u>255-2396</u>	1 LINES GP-WATER
	NPR	Y	<u>247-2833</u>	1 MANIFOLD GP-EXHAUST
	NPR	Y	<u>222-3092</u>	1 MANIFOLD GP-INLET (MID)
	NPR	Y	<u>240-3279</u>	1 PAN GP-OIL (ENGINE)
	NPR	Y	<u>117-0165</u>	1 PLUG GP-CYLINDER BLOCK (OIL GALLERY, END)
	NPR	Y	<u>227-9545</u>	1 PLUG GP-CYLINDER BLOCK (OIL GALLERY, RH)
	NPR	Y	<u>238-8962</u>	1 PLUG GP-ENGINE
	NPR	Y	<u>207-8103</u>	1 PULLEY GP-CRANKSHAFT
	NPR	Y	<u>231-1975</u>	1 SENSOR GP-ENGINE
	NPR	Y	<u>248-0716</u>	1 STARTING MOTOR GP-ELECTRIC (24-VOLT) S/N MHX1214-2760
	NPR	Y	<u>250-7017</u>	1 SUPPORT GP-ENGINE
	NPR	Y	<u>256-6004</u>	1 TURBOCHARGER GP
	NPR	Y	<u>219-7462</u>	1 WIRING GP-ELECTRONIC

CONTROL

S/N MHX1214-4886

NPR Y

306-8172

1

WIRING GP-ELECTRONIC CONTROL

S/N MHX4887-Up

NPR

231-0309

1

ELECTRONICS GP-ENGINE RATINGS

PLEASE USE THE GASKET KIT LINK IN SIS OR CONTACT YOUR LOCAL DEALER FOR THE LATEST GASKET KIT INFORMATION

Key:

Y - SEPARATE ILLUSTRATION

SMCS Codes		
1000		

Copyright 1993 - 2009 Caterpillar Inc.
 All Rights Reserved.
 Private Network For SIS Licensees.

Fri Jun 26 10:56:42 PDT 2009

Previous Screen

Product: NO EQUIPMENT SELECTED
 Model: NO EQUIPMENT SELECTED
 Configuration: NO EQUIPMENT SELECTED

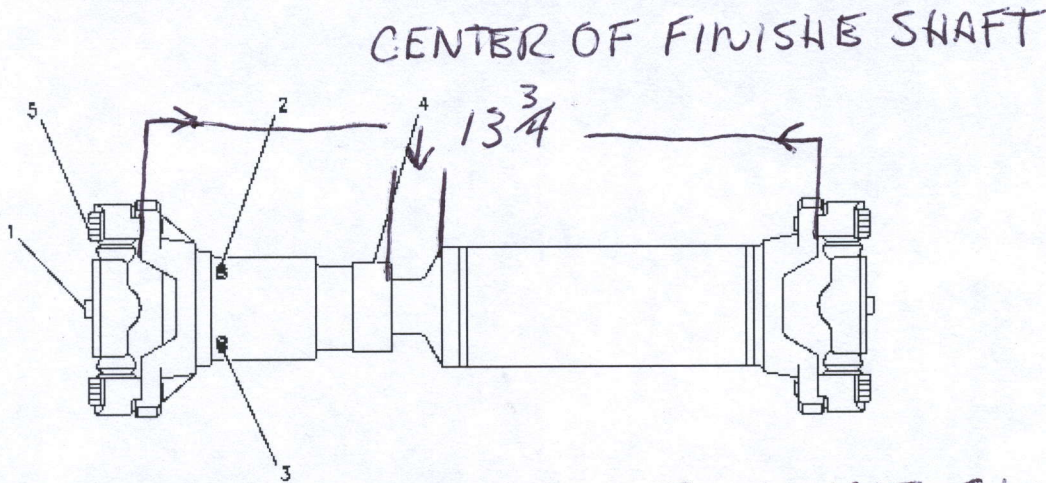

CUT SHAFT DOWN TO MAKE SLIP JOINT
 IN CENTER OF 13 3/4"

GRAPHIC #1
 g00727010

515 Wheel Skidder, Powered By 3304 Engine

Media Number - SEBP2447-53 | Publication Date - 01/01/2009 | Date

Updated - 30/01/2009

i01369300

137-6434 SLIP JOINT GP

S/N 4LR382-737

PART OF 127-5191 SHAFT GP-DRIVE

ENTIRE GROUP

Ref.	Qty.	NPR Note	Part No.	Part Name
Grp		NPR	137-6434	SLIP JOINT GP

INDIVIDUAL PARTS

Ref.	Qty.	NPR Note	Part No.	Req. Qty.	Part Name
1		NPR	9P-0356	2	SPIDER & BEARING AS
2		NPR	3B-8489	1	FITTING-GREASE
3		NPR	4K-9477	1	FITTING-PRESSURE RELIEF

4	<input type="text"/>	NPR	5V-5498	1	RETAINER
5	<input type="text"/>	NPR	139-6902	8	BOLT-12 POINT HEAD

SMCS Codes		
3251		

Copyright 1993 - 2009 Caterpillar Inc.
All Rights Reserved.
Private Network For SIS Licensees.

Fri Jun 26 11:23:50 PDT 2009

Previous Screen

Product: NO EQUIPMENT SELECTED
 Model: NO EQUIPMENT SELECTED
 Configuration: NO EQUIPMENT SELECTED

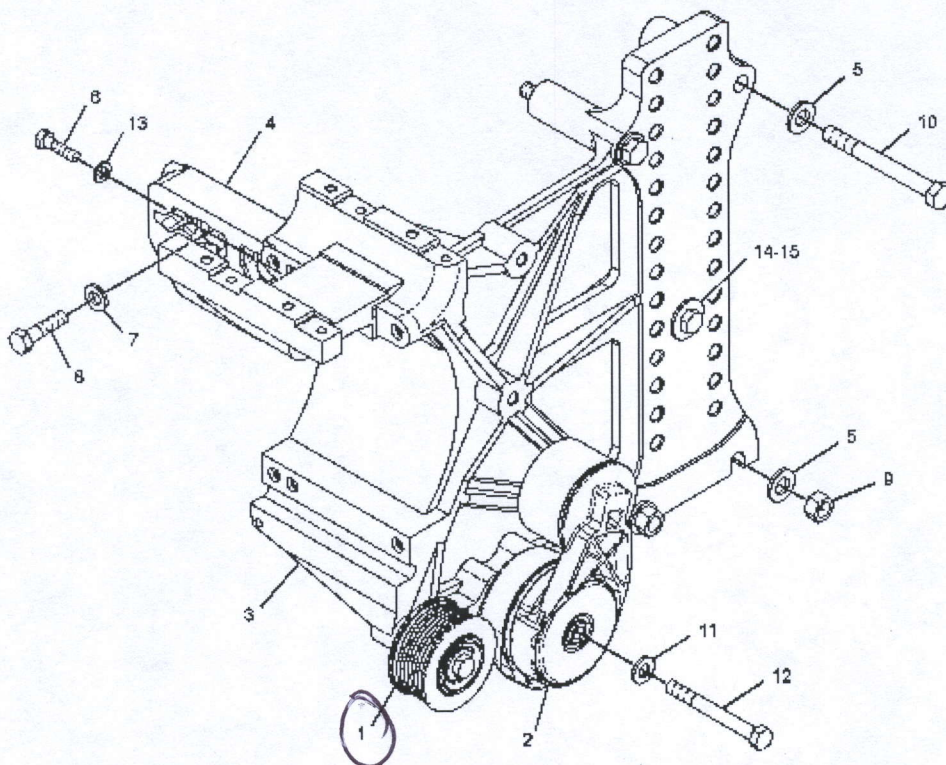

GRAPHIC #1
 g01794296

*NEED ONE FOR ALTERNATOR: BRACKET
 MODIFICATION*

16M Motor Grader, Powered By C13 Engine
 Media Number - SEBP4108-21 | Publication Date - 01/02/2009 | Date
 Updated - 18/02/2009

i03332742

260-1406 DRIVE GP-ACCESSORY
 S/N MHX1214-UP
 WITHOUT IDLER PULLEY
 PART OF 227-5359, 231-0876 ENGINE AR-COMPLETE
 AN ATTACHMENT

ENTIRE GROUP

Ref. Qty.	NPR Note	Part No.	Part Name
Grp	NPR	260-1406	DRIVE GP-ACCESSORY

INDIVIDUAL PARTS

Ref. Qty.	NPR Note	Part No.	Req. Qty.	Part Name
1	NPR	197-9642	1	PULLEY AS-IDLER (8-GROOVE)
2	NPR	211-7895	1	BELT TENSIONER

3		NPR	222-2899	1	BRACKET-SUPPORT
4		NPR	243-1557	1	BRACKET
5		NPR	5P-8245	4	WASHER-HARD (13.5X25.5X3-MM THK)
6		NPR M	6V-2317	2	BOLT (M8X1.25X30-MM)
7		NPR	6V-5839	3	WASHER (11X21X2.5-MM THK)
8		NPR M	6V-5842	3	BOLT (M10X1.5X40-MM)
9		NPR M	6V-8149	2	NUT (M12X1.75-THD)
10		NPR M	8T-0646	2	BOLT (M12X1.75X110-MM)
11		NPR	8T-4121	1	WASHER-HARD (11X21X2.5-MM THK)
12		NPR M	8T-4178	1	BOLT (M10X1.5X90-MM)
13		NPR	9M-1974	2	WASHER-HARD (8.8X16X2-MM THK)
14		NPR M	6V-6317	1	BOLT (M10X1.5X20-MM)
15		NPR	8T-4222	1	WASHER-PLATED (11X32X2.5-MM THK)

Key:

M - METRIC PART

SMCS Codes		
1207		

Previous Screen

Product: NO EQUIPMENT SELECTED
Model: NO EQUIPMENT SELECTED
Configuration: NO EQUIPMENT SELECTED

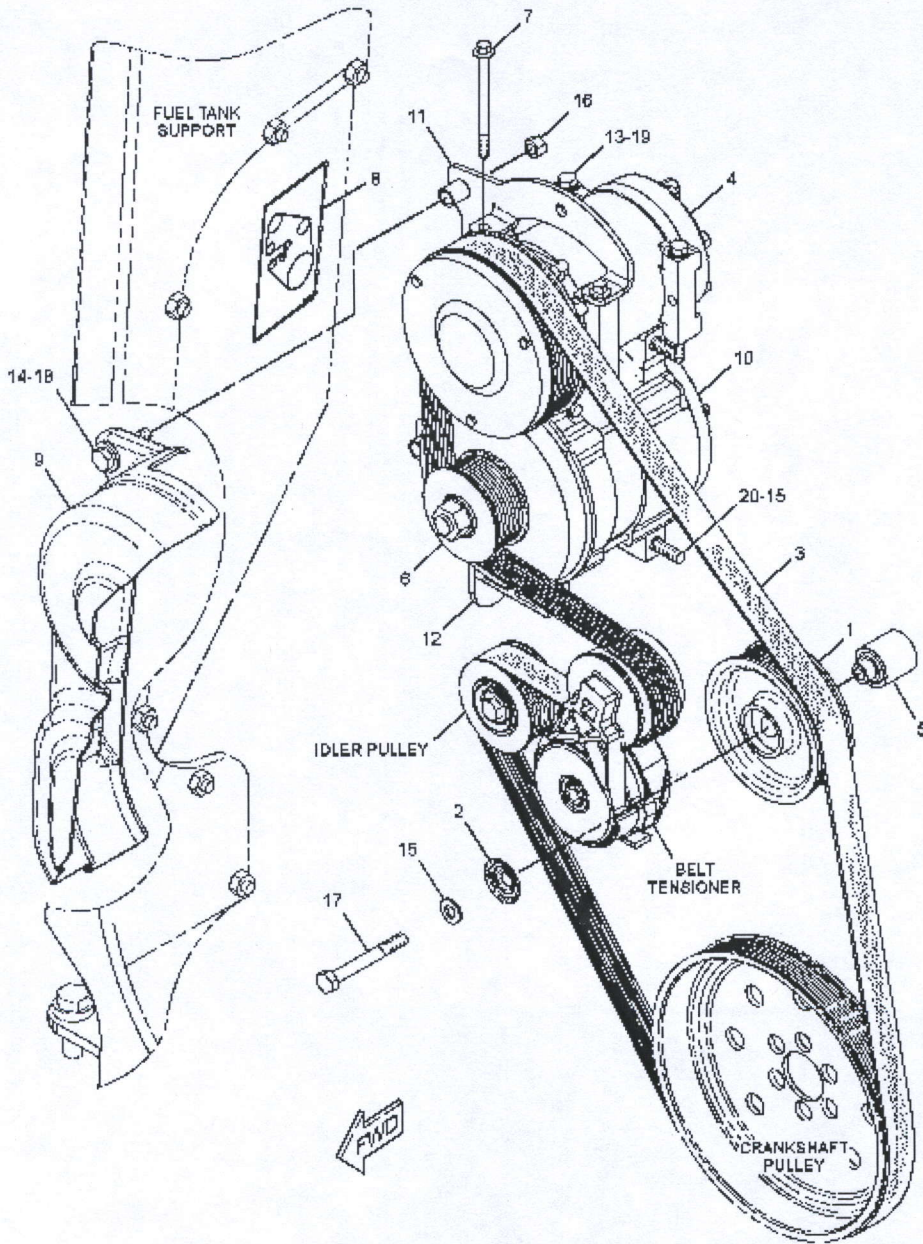

GRAPHIC #1
g01315895

USE ALL PARTS THIS PAGE

16M Motor Grader, Powered By C13 Engine

Media Number - SEBP4108-21 | Publication Date - 01/02/2009 | Date

Updated - 18/02/2009

i03202424

258-0651 DRIVE GP-ACCESSORY
S/N B9H1-UP
PART OF 285-0103 COMMON AR

ENTIRE GROUP

Ref.	Qty.	NPR Note	Part No.	Part Name
Grp	<input checked="" type="checkbox"/>	NPR	258-0651	DRIVE GP-ACCESSORY

INDIVIDUAL PARTS

Ref.	Qty.	NPR Note	Part No.	Req. Qty.	Part Name
1	<input type="checkbox"/>	NPR	124-7792	1	PULLEY AS-IDLER
2	<input type="checkbox"/>	NPR	145-2901	1	COVER-DUST
3	<input type="checkbox"/>	NPR	178-8481	1	BELT-SERPENTINE
4	<input type="checkbox"/>	NPR Y	183-5106	1	COMPRESSOR GP-REFRIGERANT
5	<input type="checkbox"/>	NPR	250-5757	1	SPACER
6	<input type="checkbox"/>	NPR	253-3996	1	PULLEY-ALTERNATOR
7	<input type="checkbox"/>	NPR M	255-1281	2	BOLT-FLANGE HEAD (M8X1.25X100-MM)
8	<input type="checkbox"/>	NPR	260-0723	1	FILM-INSTRUCTION (BELT ROUTING)
9	<input type="checkbox"/>	NPR	264-7021	1	GUARD AS-BELT
	<input type="checkbox"/>	NPR	8R-8088	2	SPACER (11.66X15.88X18-MM THK)
10	<input type="checkbox"/>	NPR	272-1088	1	ALTERNATOR GP-CHARGING (24-VOLT, 150-AMPERE)
11	<input type="checkbox"/>	NPR	302-4537	1	BRACKET AS
	<input type="checkbox"/>	NPR M	8T-3612	1	NUT-WELD (M8X1.25-THD)
	<input type="checkbox"/>	NPR	293-5895	1	BRACKET
12	<input type="checkbox"/>	NPR	293-5896	1	BRACKET
13	<input type="checkbox"/>	NPR M	7X-2538	2	BOLT (M8X1.25X100-MM)
14	<input type="checkbox"/>	NPR	7X-7729	6	WASHER (11X25X3-MM THK)
15	<input type="checkbox"/>	NPR	8T-4121	5	WASHER-HARD (11X21X2.5-MM THK)
16	<input type="checkbox"/>	NPR M	8T-4133	2	NUT (M10X1.5-THD)
17	<input type="checkbox"/>	NPR M	8T-4172	1	BOLT (M10X1.5X80-MM)
18	<input type="checkbox"/>	NPR M	8T-4182	2	BOLT (M10X1.5X45-MM)
19	<input type="checkbox"/>	NPR	8T-4224	2	WASHER-HARD (8.8X16X2-MM THK)
20	<input type="checkbox"/>	NPR M	8T-6685	4	BOLT (M10X1.5X110-MM)

Key:

M - METRIC PART
 Y - SEPARATE ILLUSTRATION

SMCS Codes		
1207		

Copyright 1993 - 2009 Caterpillar Inc.
All Rights Reserved.
Private Network For SIS Licensees.

Fri Jun 26 11:10:37 PDT 2009

Previous Screen

< Product: NO EQUIPMENT SELECTED
Model: NO EQUIPMENT SELECTED
Configuration: NO EQUIPMENT SELECTED

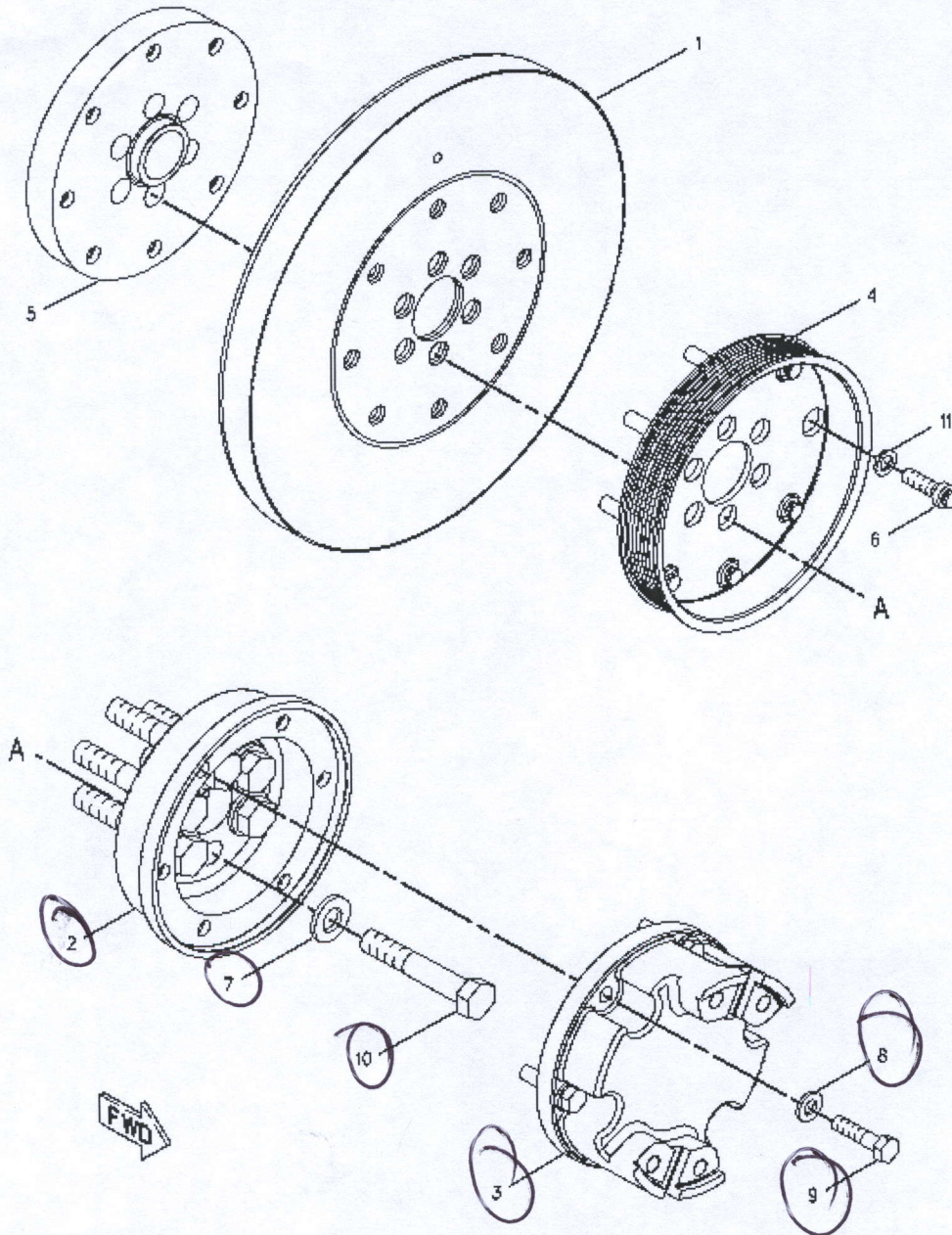

GRAPHIC #1
g00850003

16H Motor Grader, Powered By 3196 Engine
Media Number - SEBP3329-42 | Publication Date - 01/02/2009 | Date
Updated - 12/02/2009

i01643507

**174-1639 DRIVE GP-ACCESSORY
S/N 5ED478-UP
PART OF 204-7983 ENGINE AR**

ENTIRE GROUP

Ref. Qty.	NPR Note	Part No.	Part Name
Grp <input type="text"/>	<u>NPR</u>	174-1639	DRIVE GP-ACCESSORY

INDIVIDUAL PARTS

Ref. Qty.	NPR Note	Part No.	Req. Qty.	Part Name
1	<u>NPR</u>	167-8125	1	DAMPER AS
2	<u>NPR</u>	174-1593	1	ADAPTER
3	<u>NPR</u>	174-1640	1	YOKE
4	<u>NPR</u>	175-7314	1	PULLEY
5	<u>NPR</u>	179-0092	1	ADAPTER
6	<u>NPR M</u>	136-4183	8	BOLT-12 POINT HEAD (M10X1.5X30MM)
7	<u>NPR</u>	5P-8247	6	WASHER-HARD (17X32X3.5MM THK)
8	<u>NPR</u>	6V-5839	6	WASHER (11X21X2.5MM THK)
9	<u>NPR M</u>	6V-5842	6	BOLT (M10X1.50X40MM)
10	<u>NPR M</u>	8T-0358	6	BOLT (M16X2.0X90MM)
11	<u>NPR</u>	9X-2027	8	WASHER (11X18X2MM THK)

Key:

M - METRIC PART

SMCS Codes		
1207		

Previous Screen

< Product: NO EQUIPMENT SELECTED
 Model: NO EQUIPMENT SELECTED
 Configuration: NO EQUIPMENT SELECTED

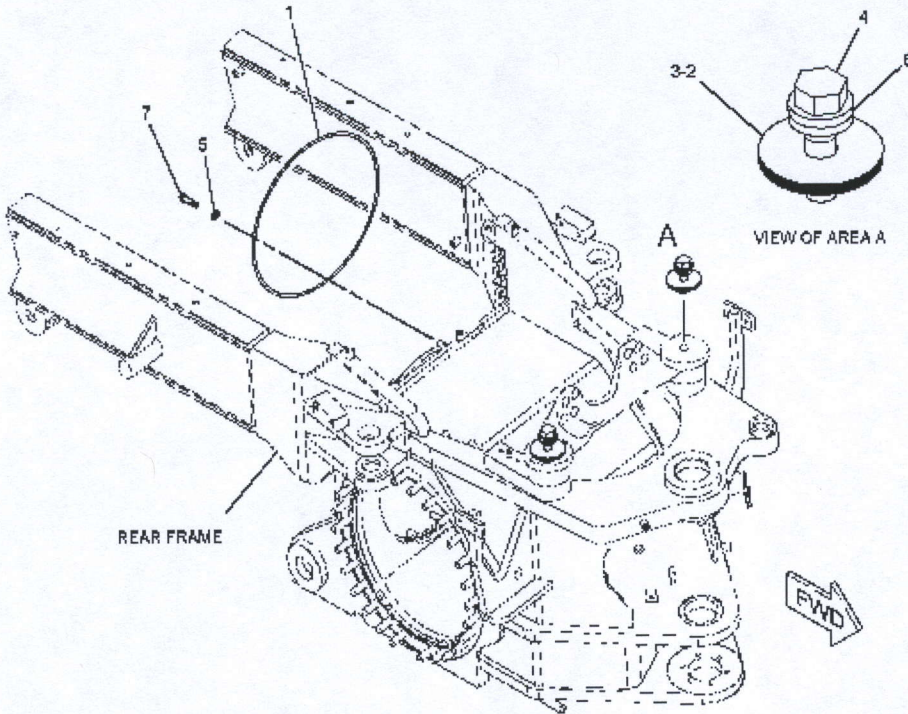

GRAPHIC #1
 g01031748

16H Motor Grader, Powered By 3196 Engine
 Media Number - SEBP3329-42 | Publication Date - 01/02/2009 | Date
 Updated - 12/02/2009

i02160556

161-2316 MOUNTING GP-ENGINE
 S/N ATS1-UP
 PART OF 162-5607 GENERAL AR

ENTIRE GROUP

Ref. Qty.	NPR Note	Part No.	Part Name
Grp <input type="text"/>		161-2316	MOUNTING GP-ENGINE

INDIVIDUAL PARTS

Ref. Qty.	NPR Note	Part No.	Req. Qty.	Part Name
1	NPR	9H-0846	1	SEAL-O-RING
2	16 NPR B	184-3266	16	SHIM (0.8MM THK)
3	16 NPR B	184-3267	16	SHIM (0.4MM THK)
4	2 NPR	1D-4638	2	BOLT (1-8X3.5-IN)

5	<input type="checkbox"/>	NPR	3K-6113	11	WASHER-HARD (12X18.5X3-MM THK)
6	<input checked="" type="checkbox"/>	NPR	5D-4661	4	WASHER-HARD (28X52.5X8-MM THK)
7	<input type="checkbox"/>	NPR	5P-8282	11	BOLT-LOCKING

Key:

B - USE AS REQUIRED

SMCS Codes		
1152	1153	1154

Copyright 1993 - 2009 Caterpillar Inc.
 All Rights Reserved.
 Private Network For SIS Licensees.

Fri Jun 26 10:50:39 PDT 2009

JOHNSON MACHINERY

CAT Service Information System

Shutdown SIS

Previous Screen

Product: NO EQUIPMENT SELECTED
 Model: NO EQUIPMENT SELECTED
 Configuration: NO EQUIPMENT SELECTED

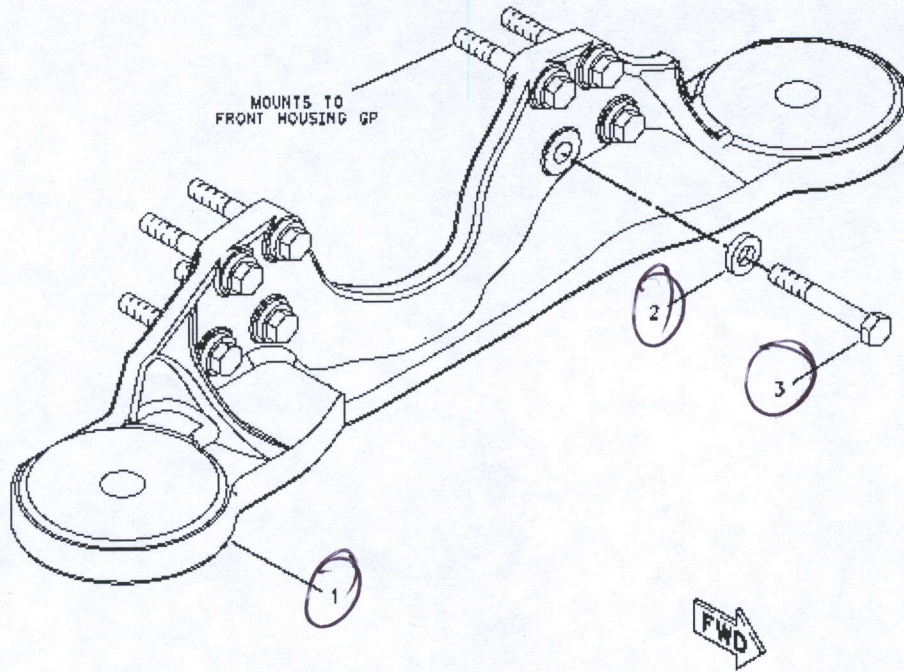

GRAPHIC #1
 g00849958

16H Motor Grader, Powered By 3196 Engine

Media Number - SEBP3329-42 | Publication Date - 01/02/2009 | Date
 Updated - 12/02/2009

i01872622

**174-1625 SUPPORT GP-ENGINE
 S/N 5ED1140-UP
 PART OF 204-7983 ENGINE AR**

ENTIRE GROUP

Ref. Qty.	NPR Note	Part No.	Part Name
Grp <input checked="" type="checkbox"/>	NPR	174-1625	SUPPORT GP-ENGINE

INDIVIDUAL PARTS

Ref. Qty.	NPR Note	Part No.	Req. Qty.	Part Name
1	NPR	230-1455	1	SUPPORT
2	NPR	2M-0849	8	WASHER-HARD (13.5X25.5X5MM THK)

3 NPR M 6V-5696 8 BOLT (M12X1.75X80MM)

Key:

M - METRIC PART

SMCS Codes		
1153	1152	1154

Copyright 1993 - 2009 Caterpillar Inc.
All Rights Reserved.
Private Network For SIS Licensees.

Fri Jun 26 11:16:31 PDT 2009

JOHNSON MACHINERY

CAT Service Information System

Shutdown SIS

Previous Screen

Product: NO EQUIPMENT SELECTED
 Model: NO EQUIPMENT SELECTED
 Configuration: NO EQUIPMENT SELECTED

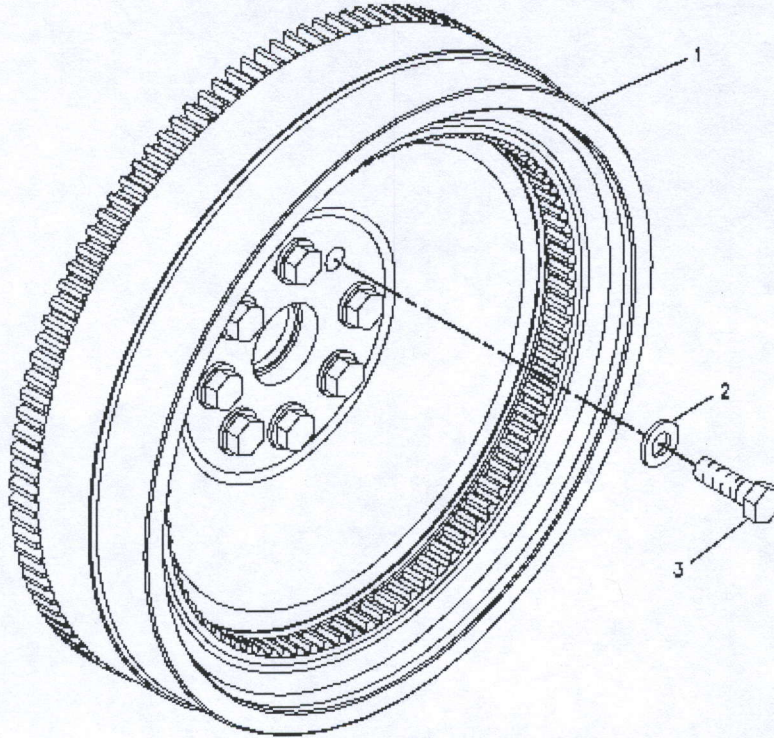

GRAPHIC #1
 g00850147

USED ALL PARTS THIS PAGE

16H Motor Grader, Powered By 3196 Engine

Media Number - SEBP3329-42 | Publication Date - 01/02/2009 | Date

Updated - 12/02/2009

i02525106

174-1766 FLYWHEEL GP

S/N 5ED478-UP

PART OF 204-7983 ENGINE AR

ENTIRE GROUP

Ref. Qty.	NPR Note	Part No.	Part Name
Grp <input checked="" type="checkbox"/>	NPR	174-1766	FLYWHEEL GP

INDIVIDUAL PARTS

Ref. Qty.	NPR Note	Part No.	Req. Qty.	Part Name
1	NPR	224-3241	1	FLYWHEEL AS
	NPR	4N-2514	1	GEAR (113-TEETH)
2	NPR	5P-8247	8	WASHER-HARD (17X32X3.5-MM)

3 THK)
 NPR M 9X-2057 8 BOLT (M16X2X50-MM)

Key:

M - METRIC PART

SMCS Codes	
1156	1158

Copyright 1993 - 2009 Caterpillar Inc.
All Rights Reserved.
Private Network For SIS Licensees.

Fri Jun 26 11:26:54 PDT 2009

JOHNSON MACHINERY

CAT Service Information System

Shutdown SIS

Previous Screen

< Product: NO EQUIPMENT SELECTED
Model: NO EQUIPMENT SELECTED
Configuration: NO EQUIPMENT SELECTED

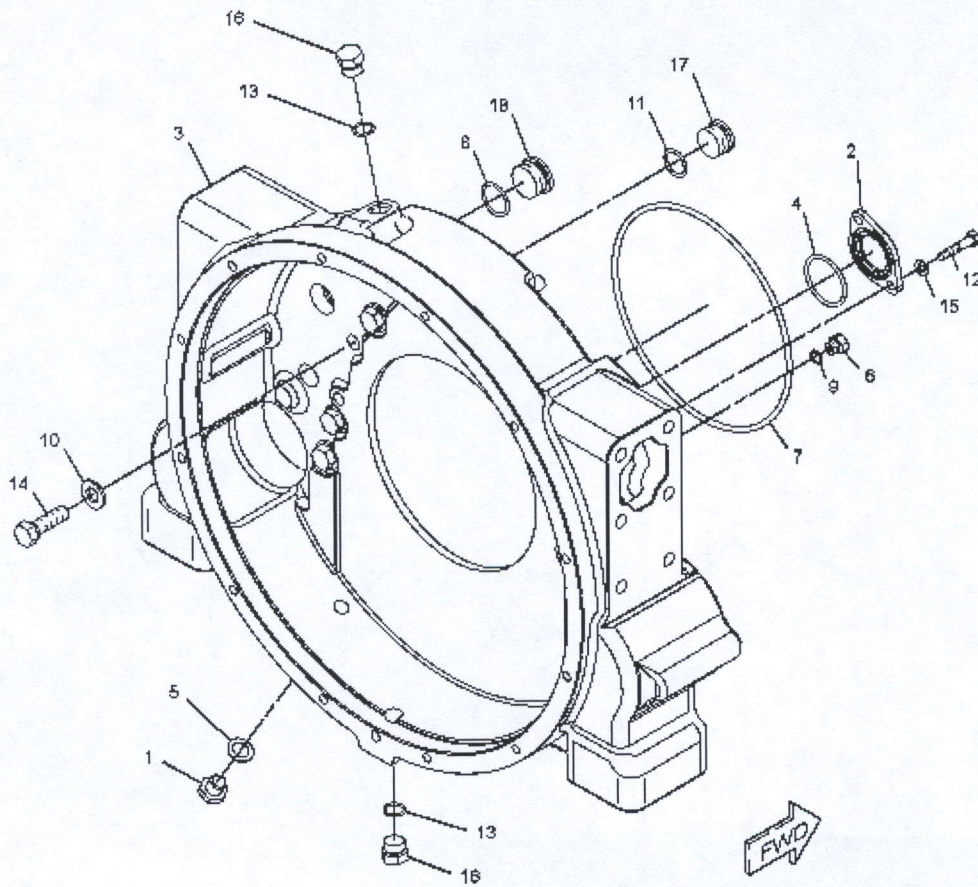

USED ALL PARTS PAGE

GRAPHIC #1
g01211232

C13 Industrial Engine
Media Number - SEBP4130-29 | Publication Date - 01/03/2009 | Date
Updated - 26/03/2009

102697763

**264-4643 HOUSING GP-FLYWHEEL
FOR USE WITH SAE #1 FLYWHEEL HOUSING
AN ATTACHMENT**

ENTIRE GROUP

Ref.	Qty.	NPR Note	Part No.	Part Name
Grp	<input checked="" type="checkbox"/>	NPR	264-4643	HOUSING GP-FLYWHEEL

INDIVIDUAL PARTS

Ref.	Qty.	NPR Note	Part No.	Req. Qty.	Part Name
1	<input type="checkbox"/>	NPR	5F-0304	1	PLUG (FLYWHEEL HOUSING)
2	<input type="checkbox"/>	NPR	7C-1445	1	COVER
3	<input type="checkbox"/>	NPR	263-4909	1	HOUSING
4	<input type="checkbox"/>	NPR	061-9455	1	SEAL-O-RING
5	<input type="checkbox"/>	NPR	2A-1162	1	GASKET
6	<input type="checkbox"/>	NPR	3K-8460	1	PLUG
7	<input type="checkbox"/>	NPR	5D-9344	1	SEAL-O-RING
8	<input type="checkbox"/>	NPR	5P-7701	1	SEAL-O-RING
9	<input type="checkbox"/>	NPR	5P-7814	1	SEAL-O-RING
10	<input type="checkbox"/>	NPR	5P-8246	12	WASHER-HARD (15.5X29X3-MM THK)
11	<input type="checkbox"/>	NPR	6V-5050	1	SEAL-O-RING
12	<input type="checkbox"/>	NPR M	6V-5219	2	BOLT (M8X1.25X40-MM)
13	<input type="checkbox"/>	NPR	8L-2786	2	SEAL-O-RING
14	<input type="checkbox"/>	NPR M	8T-0226	12	BOLT (M14X2X45-MM)
15	<input type="checkbox"/>	NPR	9M-1974	2	WASHER-HARD (8.8X16X2-MM THK)
16	<input type="checkbox"/>	NPR	9S-4185	2	PLUG-O-RING
17	<input type="checkbox"/>	NPR	9S-8008	1	PLUG-O-RING
18	<input type="checkbox"/>	NPR	9S-9334	1	PLUG-O-RING
	<input type="checkbox"/>	NPR B	1U-8846		SEALANT-GASKET

Key:

B - USE AS REQUIRED
M - METRIC PART

SMCS Codes		
1157		

JOHNSON MACHINERY

CAT Service Information System

Shutdown SIS

Previous Screen

Product: NO EQUIPMENT SELECTED
 Model: NO EQUIPMENT SELECTED
 Configuration: NO EQUIPMENT SELECTED

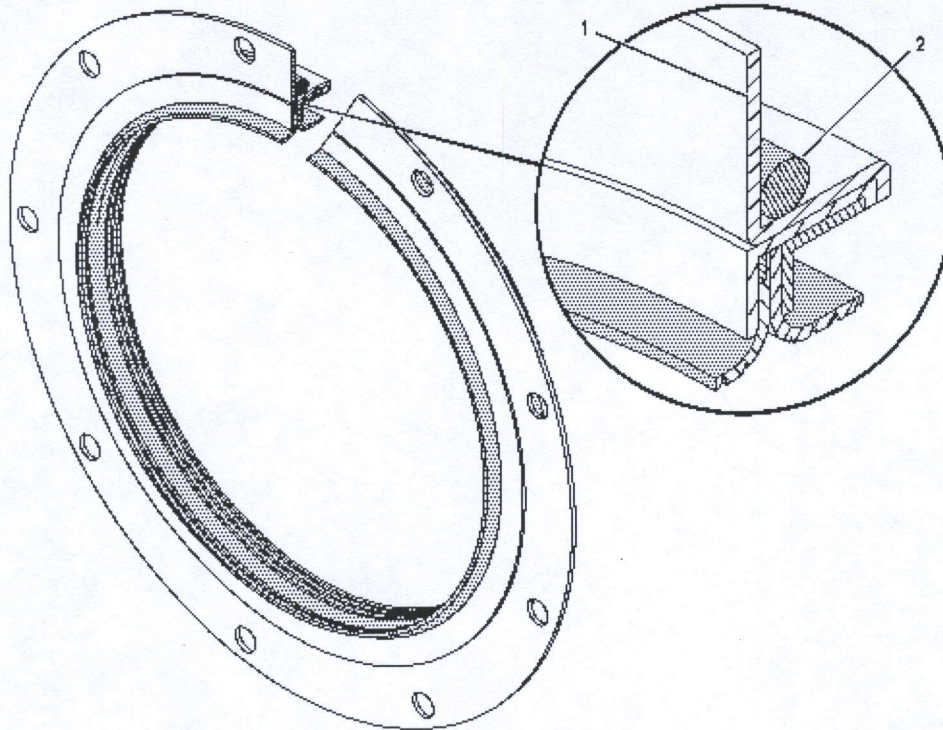

GRAPHIC #1
 g00985056

C13 Industrial Engine
 Media Number - SEBP4130-29 | Publication Date - 01/03/2009 | Date
 Updated - 26/03/2009

i01891808

227-0838 SEAL GP-CRANKSHAFT -REAR
COUNTER CLOCKWISE ROTATION
PART OF 252-6255 SEAL GP-CRANKSHAFT
AN ATTACHMENT

ENTIRE GROUP

Ref. Qty.	NPR Note	Part No.	Part Name
Grp <input checked="" type="checkbox"/>	NPR	227-0838	SEAL GP-CRANKSHAFT -REAR

INDIVIDUAL PARTS

Ref. Qty.	NPR Note	Part No.	Req. Qty.	Part Name
1	NPR	100-5421	1	SEAL GP-CRANKSHAFT
2	NPR	107-6280	1	SEAL-O-RING

SMCS Codes		
1160	1161	

Copyright 1993 - 2009 Caterpillar Inc.
All Rights Reserved.
Private Network For SIS Licensees.

Fri Jun 26 11:26:02 PDT 2009

Previous Screen

Product: NO EQUIPMENT SELECTED
 Model: NO EQUIPMENT SELECTED
 Configuration: NO EQUIPMENT SELECTED

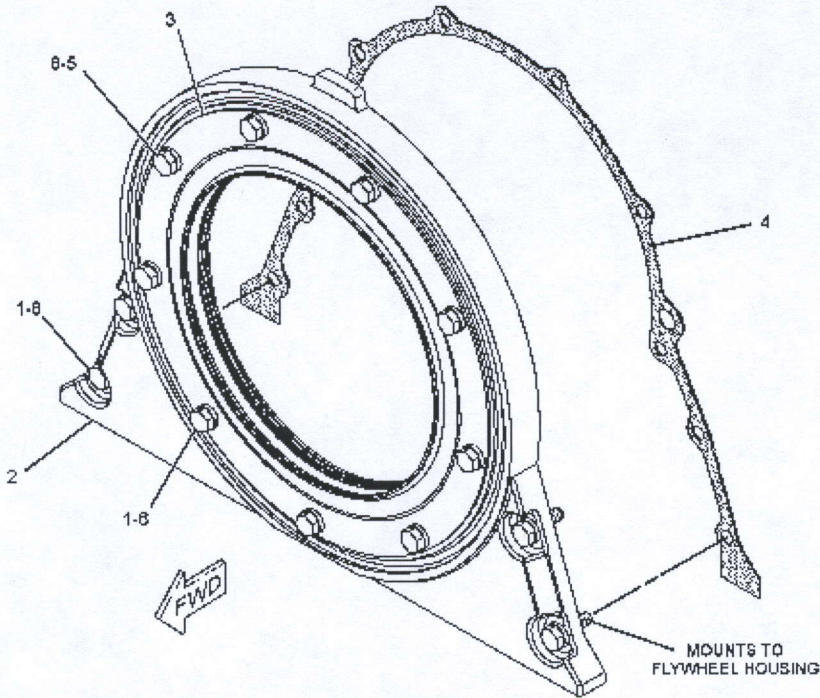

GRAPHIC #1
 g01120280

C13 Industrial Engine
 Media Number - SEBP4130-29 | Publication Date - 01/03/2009 | Date
 Updated - 26/03/2009

i02217274

**252-6255 SEAL GP-CRANKSHAFT
 FOR USE WITH WET FLYWHEEL HOUSING
 AN ATTACHMENT**

ENTIRE GROUP

Ref. Qty.	NPR Note	Part No.	Part Name
Grp <input checked="" type="checkbox"/>	NPR	252-6255	SEAL GP-CRANKSHAFT

INDIVIDUAL PARTS

Ref. Qty.	NPR Note	Part No.	Req. Qty.	Part Name
1	NPR M	9X-2022	7	BOLT-SELF-LOCKING (M6X1X20-MM)
2	NPR	160-2323	1	COVER
3	NPR Y	<u>227-0838</u>	1	SEAL GP-CRANKSHAFT

4	<input type="checkbox"/>	NPR	7C-1583	1	GASKET
5	<input type="checkbox"/>	NPR M	8T-0640	6	BOLT (M6X1X30-MM)
6	<input type="checkbox"/>	NPR	9X-8267	13	WASHER (6.6X12X2-MM THK)

Key:

M - METRIC PART
 Y - SEPARATE ILLUSTRATION

SMCS Codes		
1160	1161	

Copyright 1993 - 2009 Caterpillar Inc.
 All Rights Reserved.
 Private Network For SIS Licensees.

Fri Jun 26 11:24:46 PDT 2009

JOHNSON MACHINERY

CAT Service Information System

Shutdown SIS

Previous Screen

Product: NO EQUIPMENT SELECTED
Model: NO EQUIPMENT SELECTED
Configuration: NO EQUIPMENT SELECTED

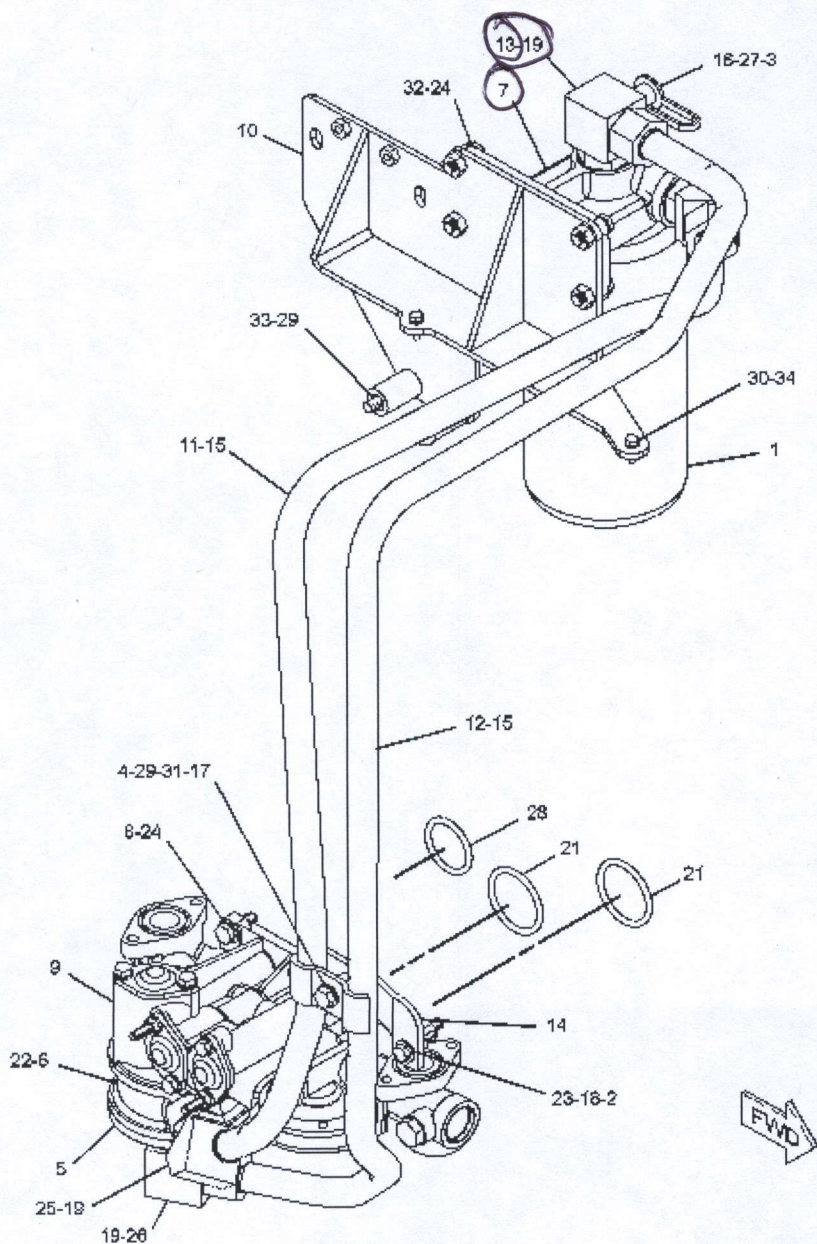

GRAPHIC #1
g01280008

16H Motor Grader, Powered By 3196 Engine
Media Number - SEBP3329-42 | Publication Date - 01/02/2009 | Date
Updated - 12/02/2009

i02550100

164-2490 FILTER GP-ENGINE OIL
S/N 5ED478-UP
PART OF 204-7983 ENGINE AR

ENTIRE GROUP

Ref.	Qty.	NPR Note	Part No.	Part Name
Grp	<input type="text"/>	NPR	164-2490	FILTER GP-ENGINE OIL

INDIVIDUAL PARTS

Ref.	Qty.	NPR Note	Part No.	Req. Qty.	Part Name
1	<input type="text"/>	NPR	1R-0716	1	FILTER AS-ENGINE OIL (STANDARD EFFICIENCY)
2	<input type="text"/>	NPR	3L-8855	1	SPACER
3	<input type="text"/>	NPR	8C-3445	1	CAP-DUST
4	<input type="text"/>	NPR	9C-5344	1	SPACER (10.5X20X18-MM THK)
5	<input type="text"/>	NPR	102-5828	1	COVER
6	<input type="text"/>	NPR	102-5829	1	ADAPTER
7	<input type="text"/>	NPR	104-7995	1	BASE GP-OIL FILTER
		NPR	2P-4304	1	STUD-HOLLOW
8	<input type="text"/>	NPR M	134-5245	6	BOLT (M10X1.5X30-MM)
9	<input type="text"/>	NPR Y	<u>166-1329</u>	1	BASE GP-OIL FILTER (ENGINE)
10	<input type="text"/>	NPR	177-4311	1	BRACKET AS
11	<input type="text"/>	NPR	185-1717	1	TUBE AS
12	<input type="text"/>	NPR	185-1718	1	TUBE AS
13	<input type="text"/>	NPR	186-3705	1	ELBOW
14	<input type="text"/>	NPR	192-7135	1	CLIP AS
		NPR M	8T-3490	4	NUT-WELD (M10X1.5-THD)
15	<input type="text"/>	NPR	106-9586	4	SEAL-O-RING
16	<input type="text"/>	NPR	3J-7354	1	SEAL-O-RING
17	<input type="text"/>	NPR	5M-7087	2	CLAMP-TUBE
18	<input type="text"/>	NPR	5P-4116	1	WASHER-HARD (8.8X20.5X2-MM THK)
19	<input type="text"/>	NPR	5P-7701	4	SEAL-O-RING
21	<input type="text"/>	NPR	6V-3831	2	SEAL-O-RING
22	<input type="text"/>	NPR	6V-3908	2	SEAL-O-RING
23	<input type="text"/>	NPR M	6V-5218	1	BOLT (M8X1.25X35-MM)
24	<input type="text"/>	NPR	6V-5839	10	WASHER (11X21X2.5-MM THK)
25	<input type="text"/>	NPR	6V-9005	2	ELBOW
26	<input type="text"/>	NPR	6V-9008	1	ELBOW
27	<input type="text"/>	NPR	8C-3446	1	VALVE-FLUID SAMPLING (ENGINE OIL)
28	<input type="text"/>	NPR	8C-5230	1	SEAL-O-RING
29	<input type="text"/>	NPR	8T-4121	3	WASHER-HARD (11X21X2.5-MM THK)
30	<input type="text"/>	NPR M	8T-4138	2	BOLT (M6X1X20-MM)

31	<input type="checkbox"/>	NPR M	8T-4186	1	BOLT (M10X1.5X40-MM)
32	<input type="checkbox"/>	NPR M	8T-4195	4	BOLT (M10X1.5X30-MM)
33	<input type="checkbox"/>	NPR M	8T-6466	2	BOLT (M10X1.5X60-MM)
34	<input type="checkbox"/>	NPR	5P-4115	2	WASHER-HARD (7.2X19X2-MM THK)

Key:

M - METRIC PART
 Y - SEPARATE ILLUSTRATION

SMCS Codes		
1308		

Copyright 1993 - 2009 Caterpillar Inc.
 All Rights Reserved.
 Private Network For SIS Licensees.

Fri Jun 26 10:44:07 PDT 2009

Previous Screen

< Product: NO EQUIPMENT SELECTED
 Model: NO EQUIPMENT SELECTED
 Configuration: NO EQUIPMENT SELECTED

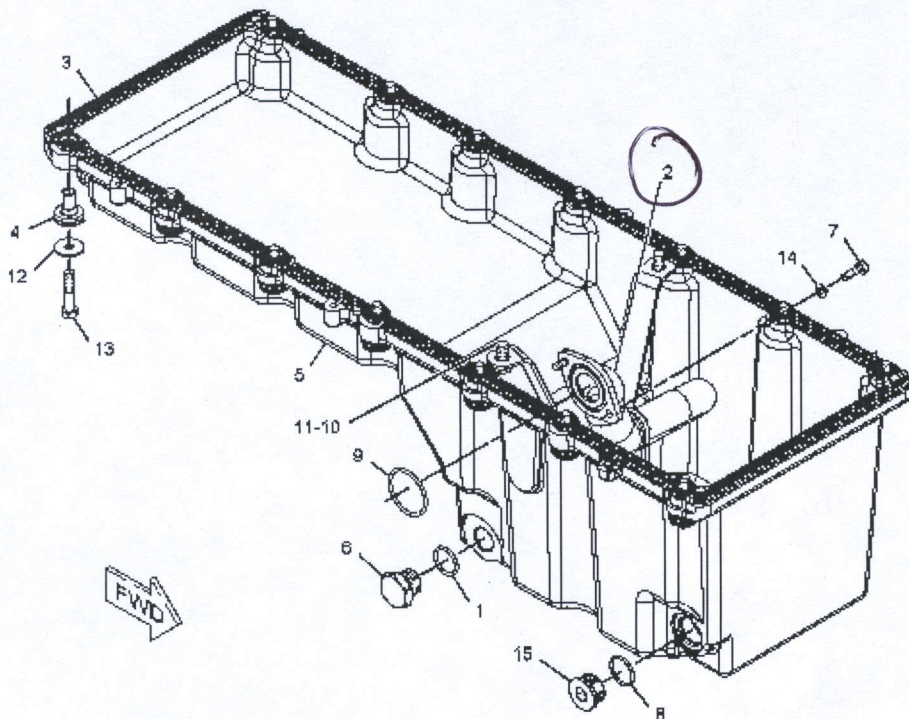

GRAPHIC #1
 g01018006

USED STOCK PAN: TURNED AROUND

C13 Industrial Engine

Media Number - SEBP4130-29 | Publication Date - 01/03/2009 | Date

Updated - 26/03/2009

i01957036

**240-3278 PAN GP-OIL -ENGINE
 34 LITER. FRONT SUMP
 AN ATTACHMENT**

ENTIRE GROUP

Ref.	Qty.	NPR Note	Part No.	Part Name
Grp		<u>NPR</u>	240-3278	PAN GP-OIL -ENGINE

INDIVIDUAL PARTS

Ref.	Qty.	NPR Note	Part No.	Req. Qty.	Part Name
1		<u>NPR</u>	9X-6451	2	PLUG-DRAIN (ENGINE OIL PAN)
2	<u>1</u>	<u>NPR</u>	210-1744	1	BELL AS-SUCTION
	<u>1</u>	<u>NPR</u>	210-1743	1	ELBOW
3		<u>NPR</u>	217-3673	1	SEAL-ISOLATION

4	<u>NPR</u>	217-3674	14	FASTENER AS
5	<u>NPR</u>	240-3277	1	PAN-OIL
6	<u>NPR</u>	061-9458	2	SEAL-O-RING
7	<u>NPR M</u>	3E-8016	2	BOLT-SELF-LOCKING (M8X1.25X25-MM)
8	<u>NPR</u>	5P-7701	2	SEAL-O-RING
9	<u>NPR</u>	5P-8211	1	SEAL-O-RING
10	<u>NPR</u>	5P-8245	2	WASHER-HARD (13.5X25.5X3-MM THK)
11	<u>NPR M</u>	6A-5591	2	BOLT (M12X1.75X25-MM)
12	<u>NPR</u>	6N-8863	14	WASHER (10.2X32X2.5-MM THK)
13	<u>NPR M</u>	6V-4249	14	BOLT (M10X1.5X50-MM)
14	<u>NPR</u>	9M-1974	2	WASHER-HARD (8.8X16X2-MM THK)
15	<u>NPR</u>	9S-9334	2	PLUG-O-RING

Key:

M - METRIC PART

SMCS Codes		
1302		

Copyright 1993 - 2009 Caterpillar Inc.
All Rights Reserved.
Private Network For SIS Licensees.

Fri Jun 26 11:06:11 PDT 2009

Previous Screen

Product: NO EQUIPMENT SELECTED
 Model: NO EQUIPMENT SELECTED
 Configuration: NO EQUIPMENT SELECTED

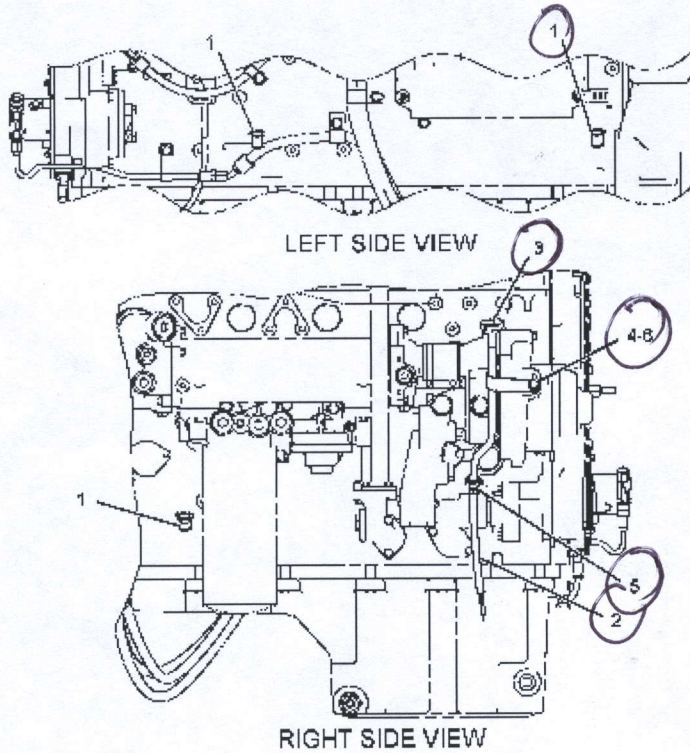

GRAPHIC #1
 g01124248

C13 Industrial Engine

Media Number - SEBP4130-29 | Publication Date - 01/03/2009 | Date
 Updated - 26/03/2009

i02208340





**257-7269 GAUGE GP-OIL LEVEL (DIPSTICK) -ENGINE
 FOR USE WITH FRONT SUMP OIL PAN
 CANNOT BE USED WITH FRONT FACING WATER INLET ELBOW
 AN ATTACHMENT**

ENTIRE GROUP

Ref. Qty.	NPR Note	Part No.	Part Name
Grp	<u>NPR</u>	257-7269	GAUGE GP-OIL LEVEL (DIPSTICK) - ENGINE

INDIVIDUAL PARTS

Ref. Qty.	NPR Note	Part No.	Req. Qty.	Part Name
1	<u>NPR J</u>	209-7309	3	PLUG
2	<u>NPR</u>	257-7270	1	TUBE AS-OIL

3		NPR	266-0771	1	GAUGE AS-OIL (DIPSTICK) (ENGINE)
4		NPR	3E-4352	1	WASHER-HARD (8.8X20.5X2.5-MM THK)
5		NPR	3P-0647	1	SEAL-O-RING
6		NPR M	6V-5217	1	BOLT (M8X1.25X20-MM)

Key:

J - USE TO PLUG OPTIONAL DIPSTICK LOCATIONS
M - METRIC PART

SMCS Codes		
1326		

Copyright 1993 - 2009 Caterpillar Inc.
All Rights Reserved.
Private Network For SIS Licensees.

Fri Jun 26 11:14:19 PDT 2009

JOHNSON MACHINERY

CAT Service Information System

Shutdown SIS

Previous Screen

Product: NO EQUIPMENT SELECTED
 Model: NO EQUIPMENT SELECTED
 Configuration: NO EQUIPMENT SELECTED

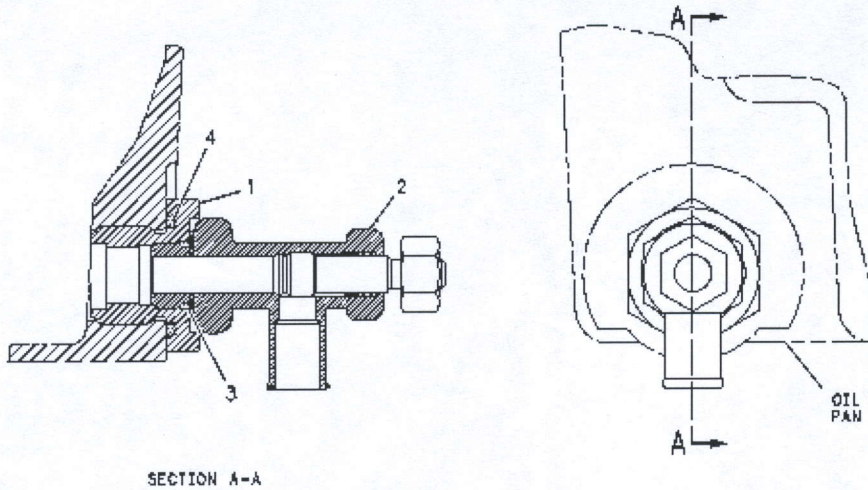

GRAPHIC #1
 g00663286

USED ALL PARTS THIS PAGE

C13 Industrial Engine

Media Number - SEBP4130-29 | Publication Date - 01/03/2009 | Date
 Updated - 26/03/2009

i03211782

**163-1383 DRAIN GP-ENGINE OIL
 ENVIRONMENTAL DRAIN
 FOR USE WITH OIL PAN
 AN ATTACHMENT**

ENTIRE GROUP

Ref. Qty.	NPR Note	Part No.	Part Name
Grp <input checked="" type="checkbox"/>	NPR	163-1383	DRAIN GP-ENGINE OIL

INDIVIDUAL PARTS

Ref. Qty.	NPR Note	Part No.	Req. Qty.	Part Name
1	NPR	3E-7427	1	ADAPTER
2	NPR	7E-4761	1	VALVE-DRAIN (ENGINE OIL)

3	<input type="text"/>	NPR	8L-2786	1	SEAL-O-RING
4	<input type="text"/>	NPR	061-9458	1	SEAL-O-RING

SMCS Codes		
1302		

Copyright 1993 - 2009 Caterpillar Inc.
All Rights Reserved.
Private Network For SIS Licensees.

Fri Jun 26 11:30:07 PDT 2009

Previous Screen

Product: NO EQUIPMENT SELECTED
Model: NO EQUIPMENT SELECTED
Configuration: NO EQUIPMENT SELECTED

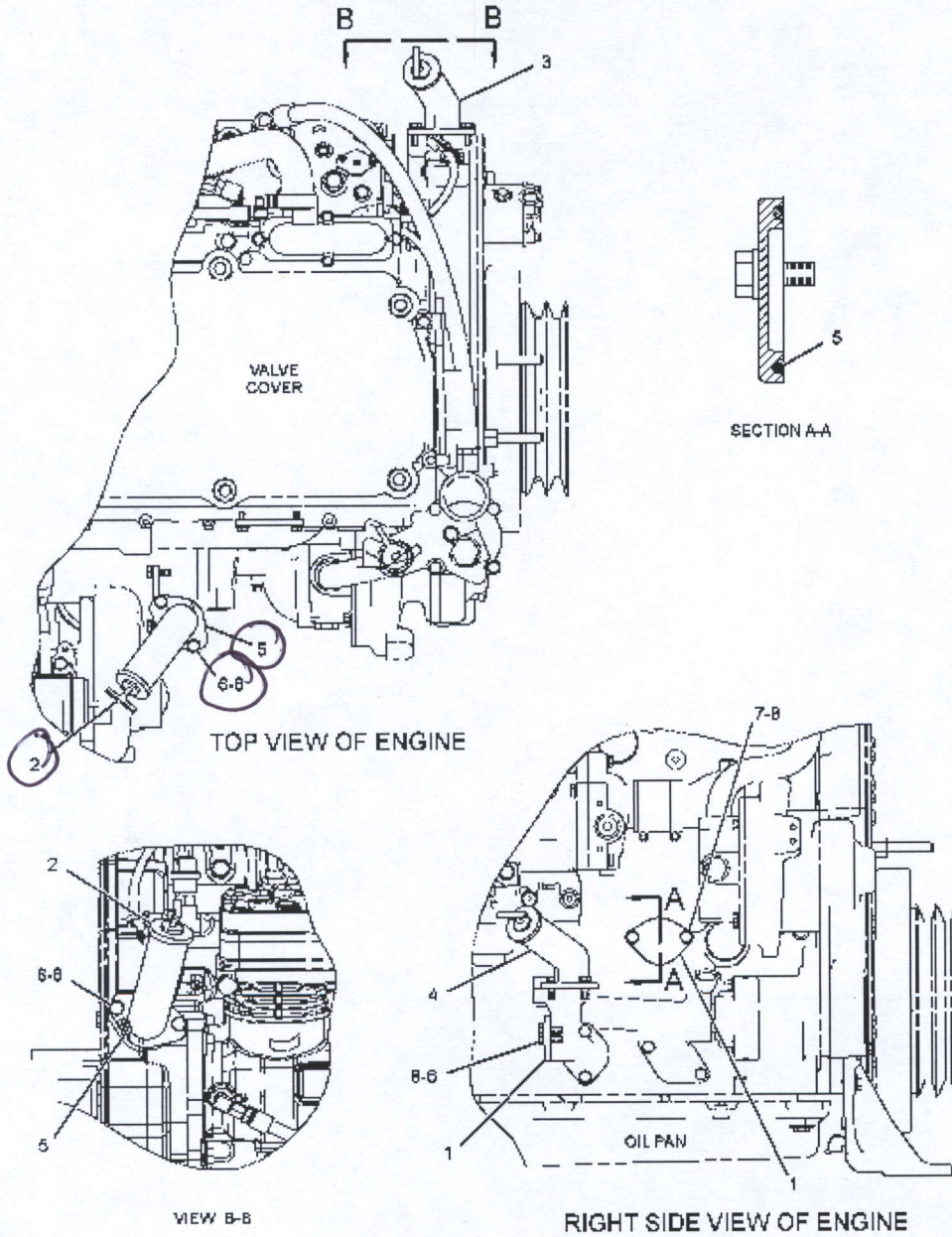

GRAPHIC #1
g01344854

C13 Industrial Engine
Media Number - SEBP4130-29 | Publication Date - 01/03/2009 | Date
Updated - 26/03/2009

i03007274

270-0508 FILLER GP-ENGINE OIL
S/N LGK1-5852
FOR USE WITH INDUSTRIAL ENGINES
CANNOT BE USED WITH FORWARD EXHAUST
AN ATTACHMENT

ENTIRE GROUP

Ref. Qty.	NPR Note	Part No.	Part Name
Grp	<u>NPR</u>	270-0508	FILLER GP-ENGINE OIL

INDIVIDUAL PARTS

Ref. Qty.	NPR Note	Part No.	Req. Qty.	Part Name
1	<u>NPR C</u>	7C-1445	2	COVER
2	<u>NPR</u>	068-4497	2	CAP-OIL FILLER (ENGINE)
3	<u>NPR C</u>	264-4288	1	TUBE-OIL FILLER
4	<u>NPR C</u>	264-4289	1	TUBE-OIL FILLER
5	<u>NPR</u>	061-9455	4	SEAL-O-RING
6	<u>NPR M</u>	6V-3940	6	BOLT (M8X1.25X25-MM)
7	<u>NPR M</u>	6V-5217	2	BOLT (M8X1.25X20-MM)
8	<u>NPR</u>	9M-1974	8	WASHER-HARD (8.8X16X2-MM THK)

Key:

C - CHANGE FROM PREVIOUS TYPE

M - METRIC PART

SMCS Codes		
1316		

Previous Screen

< Product: NO EQUIPMENT SELECTED
Model: NO EQUIPMENT SELECTED
Configuration: NO EQUIPMENT SELECTED

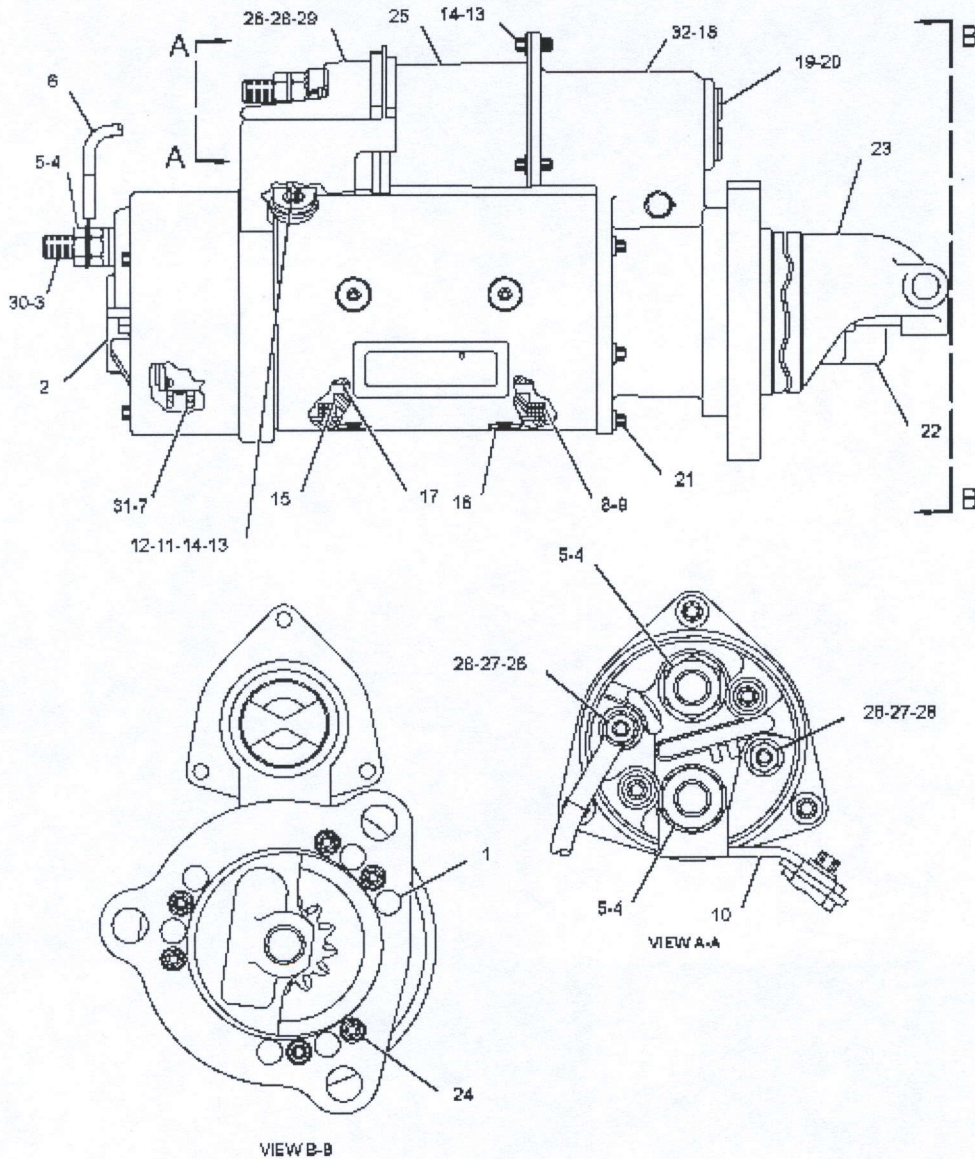

GRAPHIC #1
g01478692

16H Motor Grader, Powered By 3196 Engine
Media Number - SEBP3329-42 | Publication Date - 01/02/2009 | Date
Updated - 12/02/2009

i03486034

207-1556 STARTING MOTOR GP-ELECTRIC
S/N 5ED478-UP
24-VOLT
FIELD REPLACEMENT FOR 6V-5539, 104-7041, 6V-5582

ENTIRE GROUP

Ref.	Qty.	NPR Note	Part No.	Part Name
Grp	<input type="text" value="1"/>	NPR	207-1556	STARTING MOTOR GP-ELECTRIC
R	<input type="text" value=""/>	NPR	10R-0400	MOTOR GP-ELEC -C

INDIVIDUAL PARTS

Ref.	Qty.	NPR Note	Part No.	Req. Qty.	Part Name
1	<input type="text" value=""/>	NPR	3T-3434	6	PLUG
2	<input type="text" value=""/>	NPR	7T-3279	1	HOUSING AS
3	<input type="text" value=""/>	NPR	8T-8566	1	TERMINAL AS
4	<input type="text" value=""/>	NPR	6V-8188	4	NUT (1/2-13-THD)
5	<input type="text" value=""/>	NPR	7X-0562	4	WASHER-HARD (13.5X19X0.8-MM THK)
6	<input type="text" value=""/>	NPR	3T-3422	1	WIRE AS
7	<input type="text" value=""/>	NPR	7T-3278	1	HOLDER AS-BRUSH
8	<input type="text" value=""/>	NPR	7T-3277	1	COIL AS-FIELD
9	<input type="text" value=""/>	NPR	7T-3454	1	INSULATOR
10	<input type="text" value=""/>	NPR	283-1107	1	KIT-CONNECTOR (STARTING MOTOR) (INCLUDES CONNECTORS, BOLT & TERMINAL-STARTER)
11	<input type="text" value=""/>	NPR	7T-3451	1	KIT-INSULATOR (TERMINAL)
12	<input type="text" value=""/>	NPR	8T-8569	1	INSULATOR-TERMINAL
13	<input type="text" value=""/>	NPR	5S-7349	4	BOLT (1/4-20X0.5-IN)
14	<input type="text" value=""/>	NPR	8T-4205	4	WASHER-HARD (7.2X14.5X2-MM THK)
15	<input type="text" value=""/>	NPR	8H-1141	4	SHOE-POLE
16	<input type="text" value=""/>	NPR	3R-8797	8	SCREW & WASHER AS (3/8-24X0.72-IN)
17	<input type="text" value=""/>	NPR	7T-3276	1	ARMATURE AS (24-VOLT)
18	<input type="text" value=""/>	NPR	3E-7775	1	HOUSING AS
19	<input type="text" value=""/>	NPR	4M-1831	1	PLUG-LEVER HOUSING
20	<input type="text" value=""/>	NPR	7L-2894	1	GASKET
21	<input type="text" value=""/>	NPR	0S-1597	5	BOLT (1/4-28X1-IN)
22	<input type="text" value=""/>	NPR	6N-3826	1	DRIVE AS-MOTOR
23	<input type="text" value=""/>	NPR	7T-3974	1	HOUSING AS-DRIVE
24	<input type="text" value=""/>	NPR	7X-3373	6	BOLT (5/16-18X0.88-IN)
25	<input type="text" value=""/>	NPR	250-8279	1	KIT-SOLENOID (STARTING MOTOR) (INCLUDES SOLENOID AS, BOLT, NUTS, COVER & CONNECTORS)
26	<input type="text" value=""/>	NPR	6V-8378	3	NUT (10-32-THD)
27	<input type="text" value=""/>	NPR	8F-1434	2	LOCKWASHER

	<input type="text"/>				
28	<input type="text"/>	NPR	8T-0328	3	WASHER-HARD (5.5X10X1-MM THK)
29	<input type="text"/>	NPR	9X-4824	1	COVER-STARTING MOTOR
30	<input type="text"/>	NPR	8T-9884	1	KIT-INSULATOR (STARTING MOTOR) (INCLUDES INSULATORS & BUSHING)
31	<input type="text"/>	NPR	8C-3655	1	KIT-BRUSH (STARTING MOTOR) (INCLUDES BRUSHES, SPRINGS, SCREWS, SCREW ASSEMBLIES & SEAL)
32	<input type="text"/>	NPR	7T-3268	1	KIT-LEVER (STARTING MOTOR) (INCLUDES LEVER ASSEMBLIES, SEAL, NUT, GASKET & RETAINER)
					AVAILABLE REPAIR KIT(S):
	<input type="text"/>	NPR	7T-3267	1	KIT-BUSHING (STARTING MOTOR) (INCLUDES BUSHINGS, WICKS, CUPS, SEALS, GASKET, SCREW AS, WASHERS, SPACER & NUT)

SMCS Codes		
1453		

JOHNSON MACHINERY

CAT Service Information System

Shutdown SIS

Previous Screen

Product: NO EQUIPMENT SELECTED
 Model: NO EQUIPMENT SELECTED
 Configuration: NO EQUIPMENT SELECTED

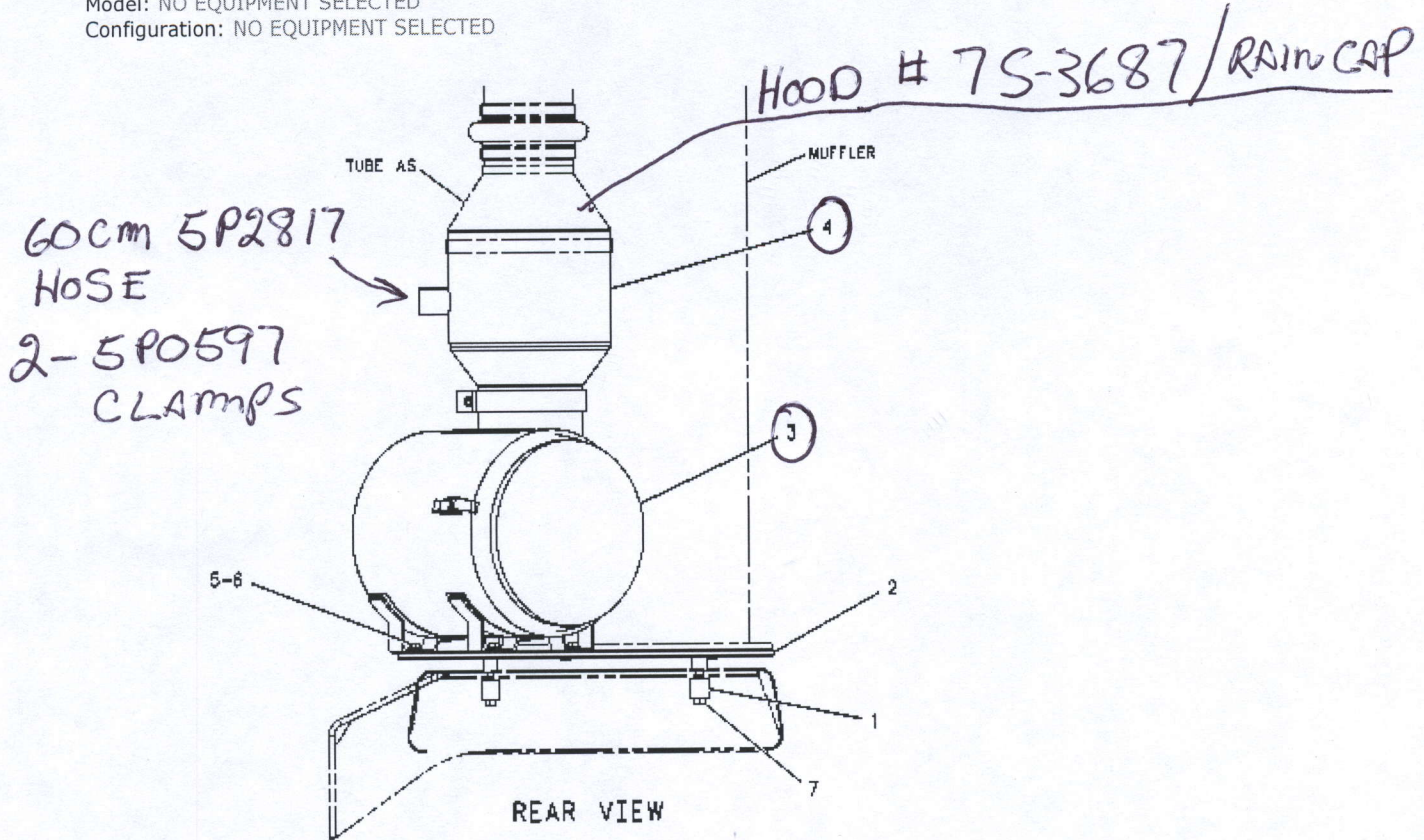

GRAPHIC #1
 g00280903

Challenger 95E Agricultural Tractor, Powered By 3196 Engine
 Media Number - SEBP2674-46 | Publication Date - 01/05/2008 | Date
 Updated - 23/05/2008

i00767796

136-5097 AIR CLEANER GP
 S/N 6KS1-UP
 PART OF 136-5095 INSTALLATION AR-ENGINE

ENTIRE GROUP

Ref.	Qty.	NPR Note	Part No.	Part Name
Grp		NPR	136-5097	AIR CLEANER GP

INDIVIDUAL PARTS

Ref.	Qty.	NPR Note	Part No.	Req. Qty.	Part Name
1		NPR	6L-7410	4	WASHER
2		NPR	142-8107	1	PLATE AS
		NPR	1F-0750	3	NUT-WELD (3/8-16-THD)

	NPR	5H-9394	4	BOSS
3	NPR Y	143-4800	1	AIR CLEANER GP
4	NPR	148-8281	1	BODY AS-PRECLEANER
5	NPR	5P-1075	4	WASHER-HARD (10.2X22.5X3-MM THK)
6	NPR	5P-8167	4	BOLT (3/8-16X0.625-IN)
7	NPR	7X-0325	4	BOLT (1/2-13X2.5-IN)

Key:

Y - SEPARATE ILLUSTRATION

SMCS Codes		
1054	1051	

Copyright 1993 - 2009 Caterpillar Inc.
 All Rights Reserved.
 Private Network For SIS Licensees.

Fri Jun 26 10:38:38 PDT 2009

Previous Screen

< Product: NO EQUIPMENT SELECTED
 Model: NO EQUIPMENT SELECTED
 Configuration: NO EQUIPMENT SELECTED

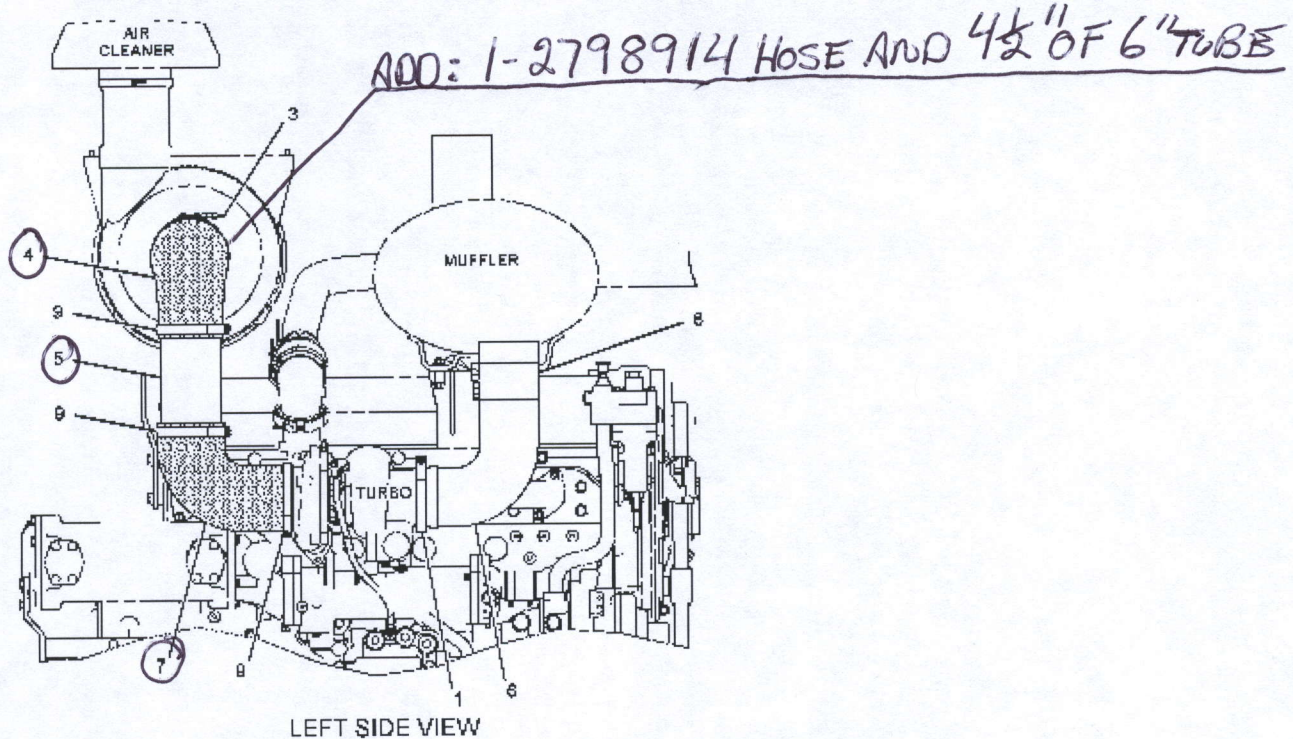

GRAPHIC #1
 g01446525

972H Wheel Loader, Powered By C13 Engine
 Media Number - SEBP3848-30 | Publication Date - 01/03/2009 | Date
 Updated - 26/03/2009

i02848765





235-1078 LINES GP-AIR
 S/N A7G1-UP
 PART OF 236-7231 INSTALLATION AR-ENGINE

ENTIRE GROUP

Ref.	Qty.	NPR Note	Part No.	Part Name
Grp		NPR	235-1078	LINES GP-AIR

INDIVIDUAL PARTS

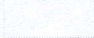
Ref.	Qty.	NPR Note	Part No.	Req. Qty.	Part Name
1		NPR	9N-1941	1	CLAMP-V-BAND
3		NPR	231-3264	1	CLAMP (BOLT SPRING)
4	1	NPR	306-8150	1	ELBOW

5		NPR	243-1676	1	TUBE AS
6		NPR	243-1677	1	TUBE AS
7		NPR	303-2024	1	ELBOW
8		NPR	241-9265	1	CLAMP-MUFFLER
9		NPR	137-8289	3	CLAMP AS

SMCS Codes		
1071		

Copyright 1993 - 2009 Caterpillar Inc.
All Rights Reserved.
Private Network For SIS Licensees.

Fri Jun 26 10:34:22 PDT 2009

Previous Screen

Product: NO EQUIPMENT SELECTED
 Model: NO EQUIPMENT SELECTED
 Configuration: NO EQUIPMENT SELECTED

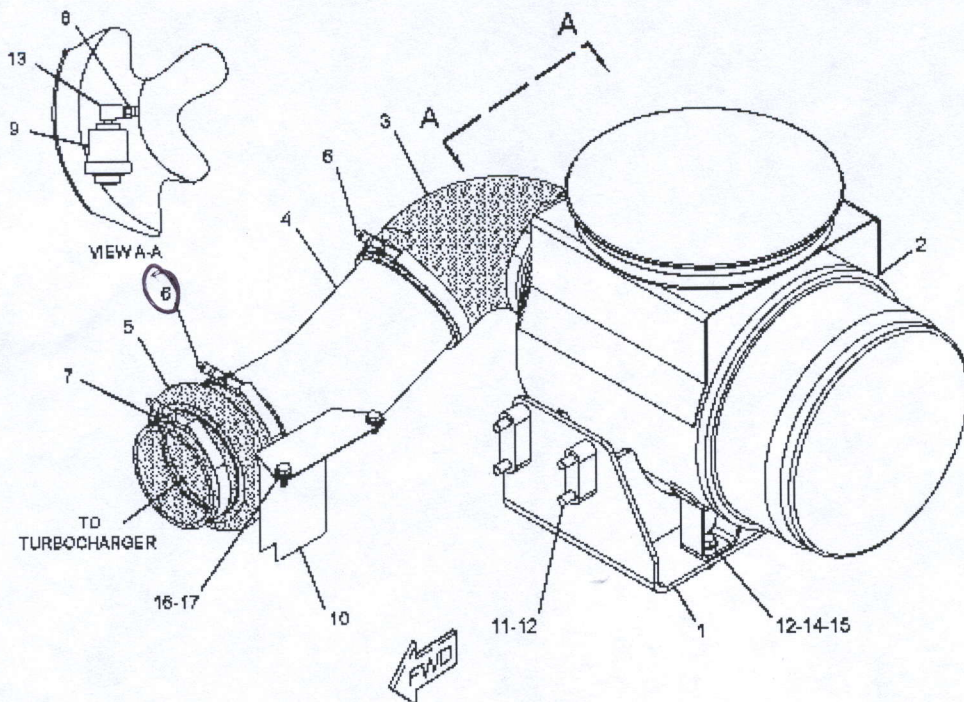

GRAPHIC #1
 g01192212

C13 Industrial Engine
 Media Number - SEBP4130-29 | Publication Date - 01/03/2009 | Date
 Updated - 26/03/2009

i02565248

243-3032 AIR CLEANER GP
 FOR USE WITH 230-6355, FRONT EXHAUST
 AN ATTACHMENT

ENTIRE GROUP

Ref.	Qty.	NPR Note	Part No.	Part Name
Grp		NPR	243-3032	AIR CLEANER GP

INDIVIDUAL PARTS

Ref.	Qty.	NPR Note	Part No.	Req. Qty.	Part Name
1		NPR	243-3033	1	BRACKET AS
2		NPR Y	163-0820	1	AIR CLEANER GP
3			158-6099	1	HOSE

4			158-4989	1	TUBE-INLET
5		NPR	4W-7731	1	HOSE-REDUCER
6	I	NPR	135-6261	3	CLAMP
7		NPR	135-6260	1	CLAMP-HOSE
8		NPR	5L-3233	1	FITTING
9		NPR	8N-2694	1	INDICATOR GP-AIR FILTER CHANGE (ENGINE)
10		NPR	243-3034	1	SHIELD
11		NPR M	6V-3823	4	BOLT (M12X1.75X60-MM)
12		NPR	5P-8245	12	WASHER-HARD (13.5X25.5X3-MM THK)
13		NPR	3B-6552	1	ELBOW-PIPE
14		NPR M	6V-8149	4	NUT (M12X1.75-THD)
15		NPR M	6V-8675	4	BOLT (M12X1.75X35-MM)
16		NPR M	6V-6317	2	BOLT (M10X1.5X20-MM)
17		NPR	6V-5839	2	WASHER (11X21X2.5-MM THK)

Key:

M - METRIC PART
Y - SEPARATE ILLUSTRATION

SMCS Codes		
1054	1051	

Previous Screen

Product: NO EQUIPMENT SELECTED
 Model: NO EQUIPMENT SELECTED
 Configuration: NO EQUIPMENT SELECTED

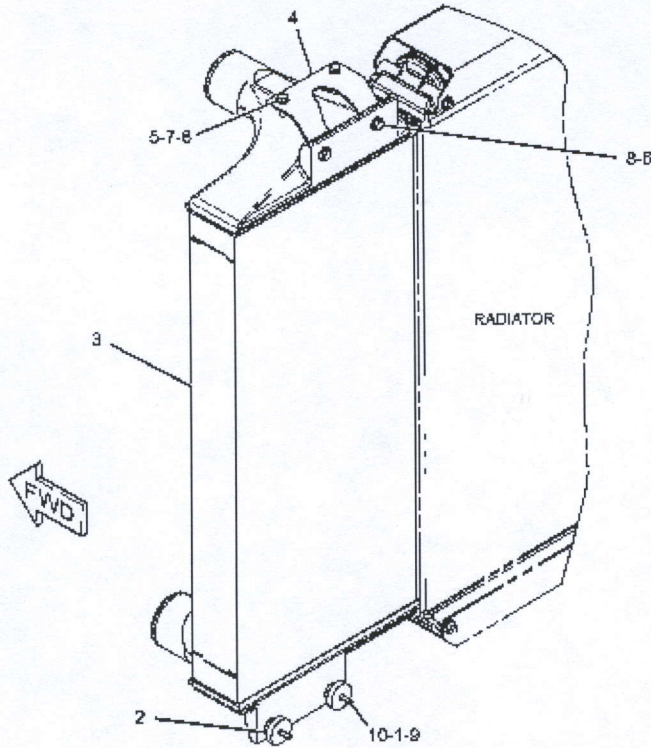

GRAPHIC #1
 g01322045

16M Motor Grader, Powered By C13 Engine

Media Number - SEBP4108-21 | Publication Date - 01/02/2009 | Date
 Updated - 18/02/2009

i02585187

249-7364 AFTERCOOLER GP-AIR
S/N B9H1-UP
PART OF 249-7363 COOLING AR

ENTIRE GROUP

Ref. Qty.	NPR Note	Part No.	Part Name
Grp <input checked="" type="checkbox"/>	NPR	249-7364	AFTERCOOLER GP-AIR

INDIVIDUAL PARTS

Ref. Qty.	NPR Note	Part No.	Req. Qty.	Part Name
1	NPR	121-3307	2	MOUNT AS-RESILIENT
2	NPR	240-9977	2	BOSS
3	NPR	260-0354	1	CORE AS-AFTERCOOLER

4	<input type="checkbox"/>	NPR	263-3993	1	BRACKET AS
	<input type="checkbox"/>	NPR M	8T-3490	2	NUT-WELD (M10X1.5-THD)
5	<input type="checkbox"/>	NPR	198-4777	2	WASHER-HARD (11X25X10-MM THK)
6	<input type="checkbox"/>	NPR	7X-7729	2	WASHER (11X25X3-MM THK)
7	<input type="checkbox"/>	NPR	8T-4121	2	WASHER-HARD (11X21X2.5-MM THK)
8	<input type="checkbox"/>	NPR M	8T-4196	4	BOLT (M10X1.5X35-MM)
9	<input type="checkbox"/>	NPR	8T-4226	2	WASHER-PLATED (10.5X45X3-MM THK)
10	<input type="checkbox"/>	NPR M	8T-6870	2	BOLT (M8X1.25X70-MM)

Key:

M - METRIC PART

SMCS Codes		
1079	1063	1064

Copyright 1993 - 2009 Caterpillar Inc.
 All Rights Reserved.
 Private Network For SIS Licensees.

Fri Jun 26 11:04:03 PDT 2009

Previous Screen

Product: NO EQUIPMENT SELECTED
 Model: NO EQUIPMENT SELECTED
 Configuration: NO EQUIPMENT SELECTED

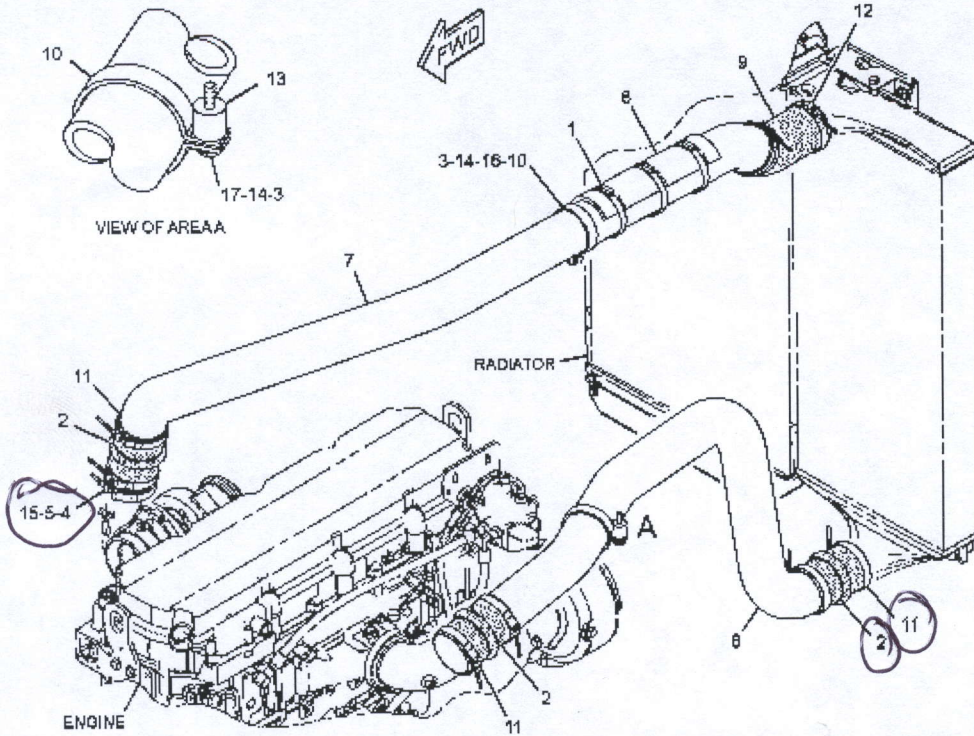

GRAPHIC #1
 g01419979

16M Motor Grader, Powered By C13 Engine

Media Number - SEBP4108-21 | Publication Date - 01/02/2009 | Date
 Updated - 18/02/2009

i02838436

249-7322 LINES GP-AIR

S/N B9H1-UP

PART OF 285-0103 COMMON AR

ENTIRE GROUP

Ref.	Qty.	NPR Note	Part No.	Part Name
Grp		NPR	249-7322	LINES GP-AIR

INDIVIDUAL PARTS

Ref.	Qty.	NPR Note	Part No.	Req. Qty.	Part Name
1		NPR	5P-1717	3	CLAMP-HOSE
2		NPR	7E-8630	3	HOSE-AIR INLET
3		NPR	9R-5008	2	SPACER (11X20X6-MM THK)

4	1	NPR	127-0929	1	CLAMP
5	1	NPR	129-6400	1	ADAPTER
6		NPR	260-1863	1	TUBE
7		NPR	260-1864	1	TUBE
8		NPR	263-3989	1	SHIELD-HEAT
9		NPR	274-1707	1	HOSE
10		NPR	133-9229	2	CLIP
11	6	NPR	208-7448	6	CLAMP
12		NPR	216-2211	2	CLAMP
13		NPR	298-2011	1	SPACER (11X30X30-MM THK)
14		NPR	7X-7729	2	WASHER (11X25X3-MM THK)
15	1	NPR	8C-3089	1	SEAL-O-RING
16		NPR M	8T-4186	1	BOLT (M10X1.5X40-MM)
17		NPR M	8T-5005	1	BOLT (M10X1.5X70-MM)

Key:

M - METRIC PART

SMCS Codes		
1071		

Previous Screen

Product: NO EQUIPMENT SELECTED
 Model: NO EQUIPMENT SELECTED
 Configuration: NO EQUIPMENT SELECTED

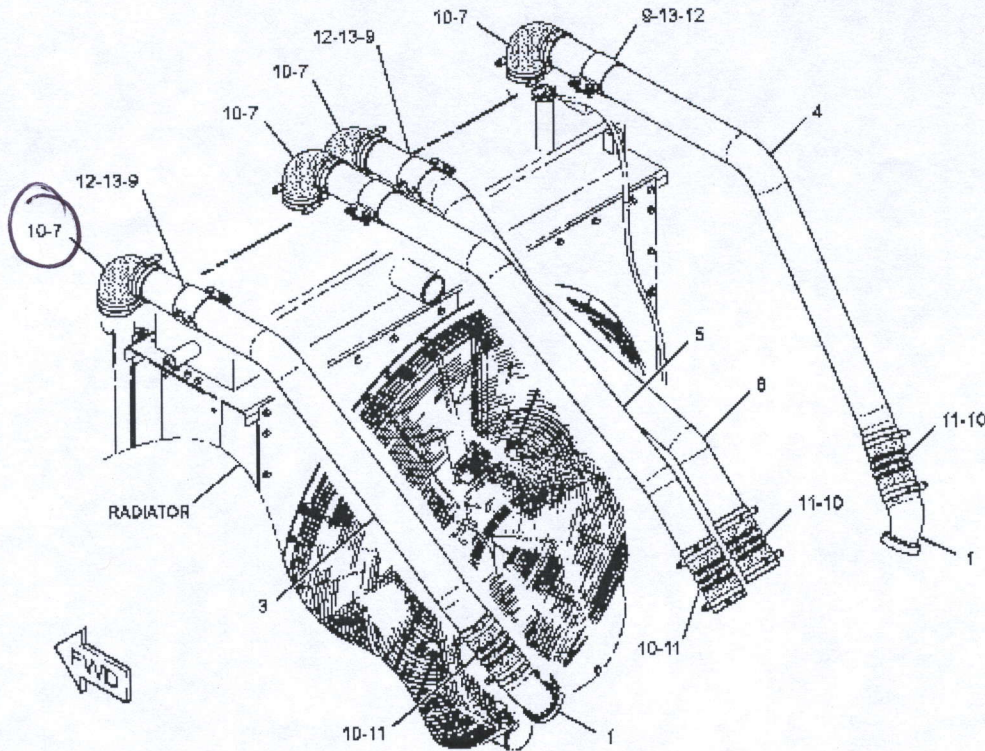

GRAPHIC #1
g01458301

777F Off-Highway Truck, Powered By C32 Engine
 Media Number - SEBP4305-45 | Publication Date - 01/06/2009 | Date
 Updated - 19/06/2009

i02919771

243-5147 LINES GP-AIR -ATAAC
 S/N JRP1-UP
 PART OF 235-3367 INSTALLATION AR-ENGINE

ENTIRE GROUP

Ref.	Qty.	NPR Note	Part No.	Part Name
Grp		NPR	243-5147	LINES GP-AIR -ATAAC

INDIVIDUAL PARTS

Ref.	Qty.	NPR Note	Part No.	Req. Qty.	Part Name
1		NPR Y	126-0079	2	LINES GP-AIR (TURBOCHARGER OUTLET)
3		NPR	317-6704	1	TUBE
4		NPR	317-6705	1	TUBE

5		NPR	252-2297	1	TUBE
6		NPR	252-2298	1	TUBE
7	4	NPR	258-0817	4	HOSE
9		NPR	156-5745	8	CLAMP-HALF
10	8	NPR	9X-2201	32	CLAMP-HOSE
11		NPR	186-2002	4	HOSE
12		NPR	8T-4223	8	WASHER-HARD (13.5X25.5X3-MM THK)
13		NPR M	8T-4956	8	BOLT (M12X1.75X35-MM)

Key:

M - METRIC PART
 Y - SEPARATE ILLUSTRATION

SMCS Codes		
1071		

Copyright 1993 - 2009 Caterpillar Inc.
 All Rights Reserved.
 Private Network For SIS Licensees.

Fri Jun 26 10:39:39 PDT 2009

Previous Screen

Product: NO EQUIPMENT SELECTED
 Model: NO EQUIPMENT SELECTED
 Configuration: NO EQUIPMENT SELECTED

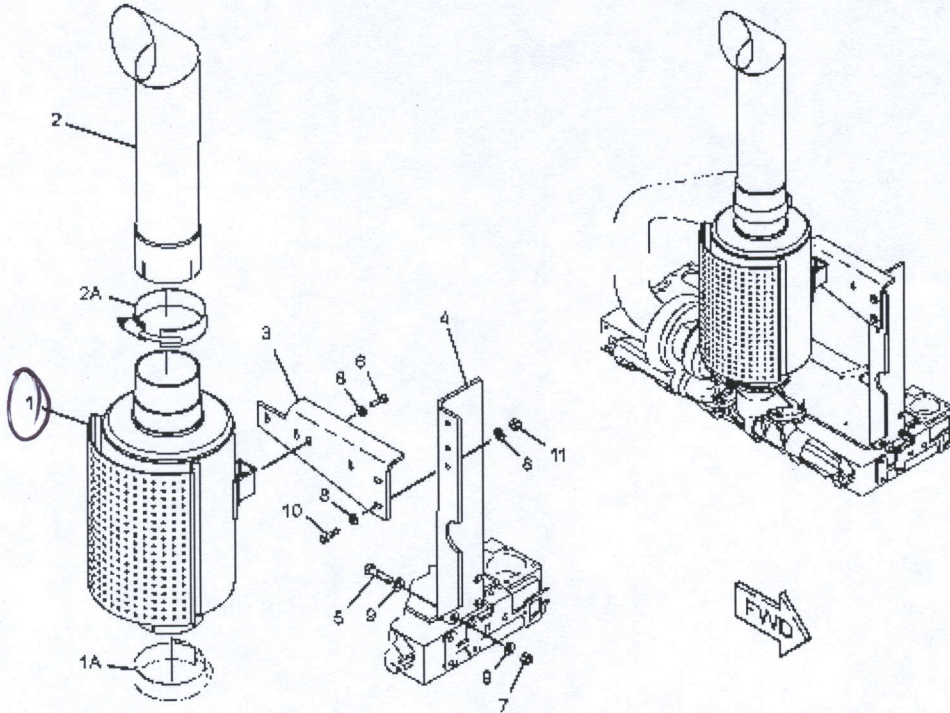

GRAPHIC #1
 g01279570

D7G2 TRACK-TYPE TRACTOR, Powered By 3306 Engine
 Media Number - SEBP5047-02 | Publication Date - 01/03/2009 | Date
 Updated - 16/03/2009

i03348257

270-4121 MUFFLER GP
S/N 7MB5000-UP
PART OF 270-4120 INSTALLATION AR-ENGINE

ENTIRE GROUP

Ref.	Qty.	NPR Note	Part No.	Part Name
Grp	<input type="text"/>	NPR	270-4121	MUFFLER GP

INDIVIDUAL PARTS

Ref.	Qty.	NPR Note	Part No.	Req. Qty.	Part Name
1	<input type="text"/>	NPR	1W-9229	1	MUFFLER AS
1A	<input type="text"/>	NPR	141-1480	1	CLAMP AS
2	<input type="text"/>	NPR	132-2745	1	EXTENSION GP-EXHAUST

2A	<input type="text"/>	NPR	141-1480	1	CLAMP AS
3	<input type="text"/>	NPR	270-4133	1	BRACKET
4	<input type="text"/>	NPR	270-4135	1	SUPPORT
5	<input type="text"/>	NPR	1A-1460	2	BOLT (1/2-13X2-IN)
6	<input type="text"/>	NPR	1A-2029	2	BOLT (3/8-16X1.125-IN)
7	<input type="text"/>	NPR	1F-7958	2	NUT-FULL (1/2-13-THD)
8	<input type="text"/>	NPR	5P-1075	6	WASHER-HARD (10.2X22.5X3-MM THK)
9	<input type="text"/>	NPR	5P-8245	4	WASHER-HARD (13.5X25.5X3-MM THK)
10	<input type="text"/>	NPR	5S-7382	2	BOLT (3/8-16X1.375-IN)
11	<input type="text"/>	NPR	6V-8801	2	NUT (3/8-16-THD)

SMCS Codes		
1062	<input type="text"/>	<input type="text"/>

Copyright 1993 - 2009 Caterpillar Inc.
 All Rights Reserved.
 Private Network For SIS Licensees.

Fri Jun 26 10:29:12 PDT 2009

Previous Screen

< Product: NO EQUIPMENT SELECTED
Model: NO EQUIPMENT SELECTED
Configuration: NO EQUIPMENT SELECTED

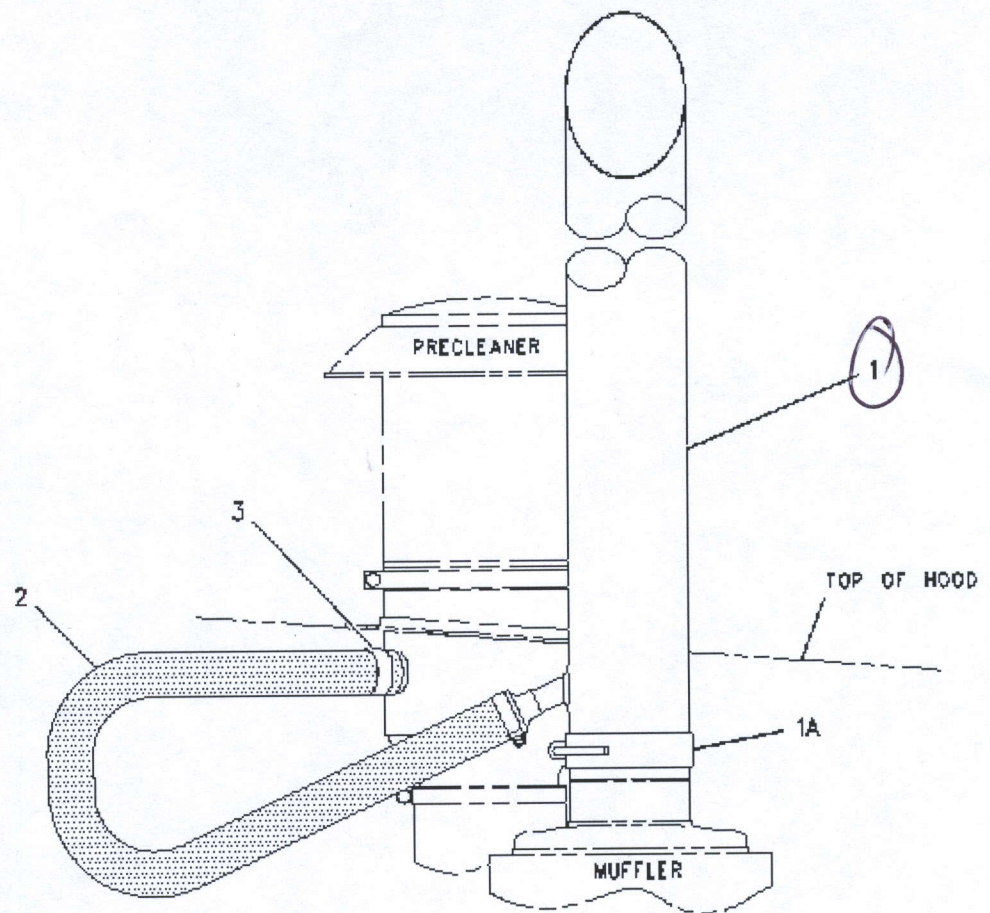

RIGHT SIDE VIEW

GRAPHIC #1
g00903300

D7R Track-Type Tractor, Powered By 3176C Engine
Media Number - SEBP2950-49 | Publication Date - 01/02/2009 | Date
Updated - 03/02/2009

i01765607

171-4357 DUST EJECTOR GP
S/N ACS1-UP; ADW1-UP
PART OF 160-8555 INSTALLATION AR-ENGINE

ENTIRE GROUP

Ref. Qty.	NPR Note	Part No.	Part Name
-----------	----------	----------	-----------

Grp NPR 171-4357 DUST EJECTOR GP

INDIVIDUAL PARTS

Ref.	Qty.	NPR Note	Part No.	Req. Qty.	Part Name
1	<input type="text"/>	NPR	155-2819	1	EJECTOR AS-EXHAUST
1A	<input type="text"/>	NPR	141-1480	1	CLAMP AS
2	<input type="text"/>	NPR E	5P-2817		HOSE (65CM)
3	<input type="text"/>	NPR	9M-2904	2	CLAMP-HOSE

Key:

E - ORDER BY THE CENTIMETER

SMCS Codes		
1068	<input type="text"/>	<input type="text"/>

Copyright 1993 - 2009 Caterpillar Inc.
 All Rights Reserved.
 Private Network For SIS Licensees.

Fri Jun 26 10:45:48 PDT 2009

Previous Screen

Product: NO EQUIPMENT SELECTED
 Model: NO EQUIPMENT SELECTED
 Configuration: NO EQUIPMENT SELECTED

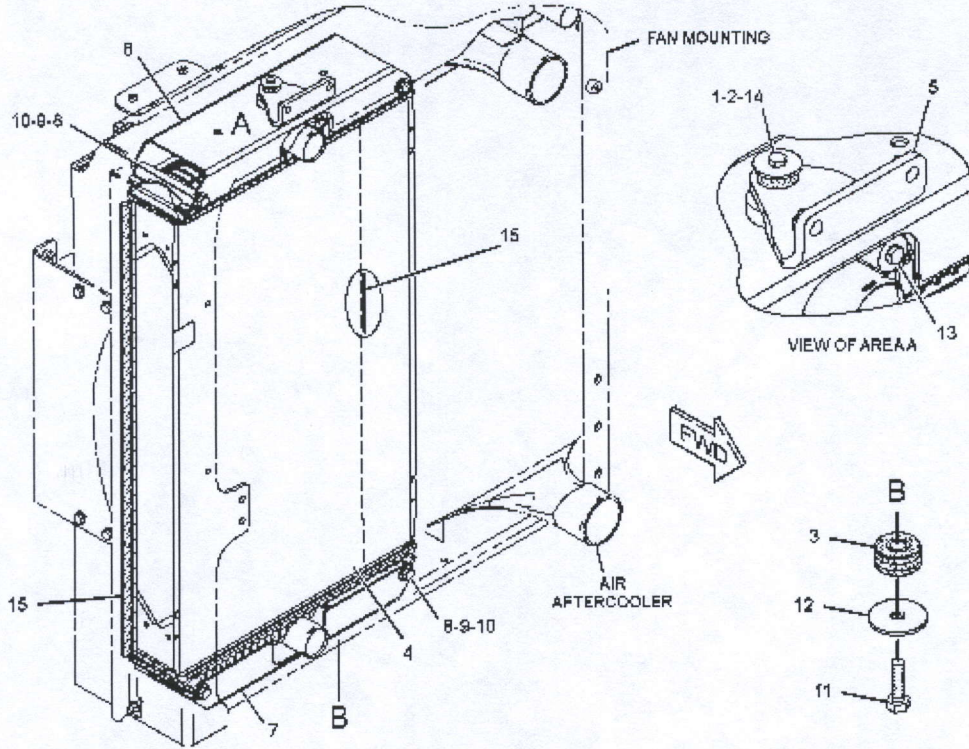

GRAPHIC #1
 g01326917

16M Motor Grader, Powered By C13 Engine

Media Number - SEBP4108-21 | Publication Date - 01/02/2009 | Date Updated - 18/02/2009

i02585231

249-7367 RADIATOR GP

S/N B9H1-UP

PART OF 249-7363 COOLING AR

ENTIRE GROUP

Ref. Qty.	NPR Note	Part No.	Part Name
Grp <input checked="" type="checkbox"/>	NPR	249-7367	RADIATOR GP

INDIVIDUAL PARTS

Ref. Qty.	NPR Note	Part No.	Req. Qty.	Part Name
1	NPR	121-3307	1	MOUNT AS-RESILIENT (RUBBER)
2	NPR M	174-4181	1	WASHER-HARD (8.5X40X3-MM THK)
3	NPR	243-2289	2	MOUNT AS (RUBBER)

4		256-5311	1	CORE AS-RADIATOR
5	<u>NPR</u>	263-3960	1	BRACKET AS
	<u>NPR M</u>	8T-3490	2	NUT-WELD (M10X1.5-THD)
6	<u>NPR</u>	263-3962	1	BRACKET AS
7	<u>NPR</u>	263-3994	1	BRACKET AS
8	<u>NPR M</u>	7X-2546	4	BOLT (M10X1.5X180-MM)
9	<u>NPR</u>	7X-7729	8	WASHER (11X25X3-MM THK)
10	<u>NPR M</u>	8T-4133	4	NUT (M10X1.5-THD)
11	<u>NPR M</u>	8T-4196	2	BOLT (M10X1.5X35-MM)
12	<u>NPR</u>	8T-4226	2	WASHER-PLATED (10.5X45X3-MM THK)
13	<u>NPR</u>	8T-6765	1	PLUG-PIPE
14	<u>NPR M</u>	8T-6912	1	BOLT (M8X1.25X50-MM)
15	<u>NPR D</u>	5P-8309		SEAL (1.1-M EACH)

Key:

D - ORDER BY THE METER
M - METRIC PART

SMCS Codes		
1353		

Copyright 1993 - 2009 Caterpillar Inc.
All Rights Reserved.
Private Network For SIS Licensees.

Fri Jun 26 10:53:34 PDT 2009

JOHNSON MACHINERY

CAT Service Information System

Shutdown SIS

Previous Screen

Product: NO EQUIPMENT SELECTED
Model: NO EQUIPMENT SELECTED
Configuration: NO EQUIPMENT SELECTED

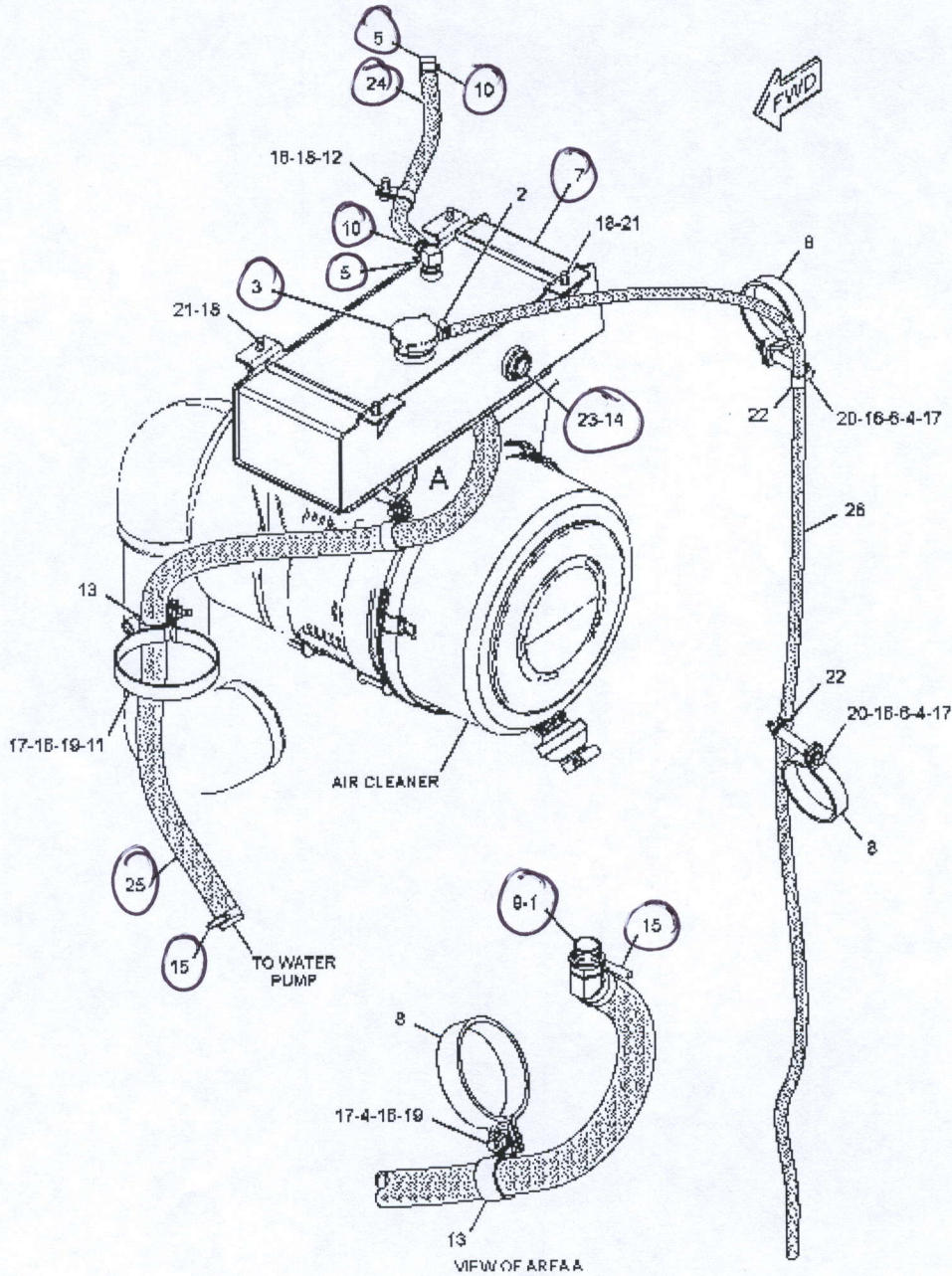

GRAPHIC #1
g01595593

16M Motor Grader, Powered By C13 Engine

Media Number - SEBP4108-21 | Publication Date - 01/02/2009 | Date
Updated - 18/02/2009

103112583

257-7500 TANK GP-COOLANT
S/N B9H1-UP
PART OF 285-0103 COMMON AR

ENTIRE GROUP

Ref.	Qty.	NPR Note	Part No.	Part Name
Grp		NPR	257-7500	TANK GP-COOLANT

INDIVIDUAL PARTS

Ref.	Qty.	NPR Note	Part No.	Req. Qty.	Part Name
1	1	NPR	5P-1230	1	CONNECTOR
2		NPR	5P-4961	1	CLAMP-HOSE
3	1	NPR	6L-8617	1	CAP-PRESSURE (7-PSI) (EXPANSION TANK)
4		NPR	9R-5008	3	SPACER (11X20X6-MM THK)
5	2	NPR	150-3026	2	ELBOW AS (EACH INCLUDES)
		NPR	6V-4292	1	ELBOW
		NPR	3K-0360	1	SEAL-O-RING
6		NPR	8W-1253	2	SPACER (11.06X15.88X60-MM THK)
7	1	NPR	274-7610	1	TANK AS-COOLANT
		NPR	7J-5225	1	FITTING (1-1/16-12-THD)
		NPR M	8T-3612	4	NUT-WELD (M8X1.25-THD)
		NPR	133-0661	1	BOSS
		NPR	151-3015	1	NECK AS
		NPR	8N-8846	1	NECK-FILLER
		NPR	3L-5893	1	TUBE-OVERFLOW
8		NPR	133-9229	3	CLIP
9	1	NPR	3D-2824	1	SEAL-O-RING
10	2	NPR	5D-1026	2	CLAMP-HOSE
11		NPR	151-8190	1	CLAMP
12		NPR	6D-4244	1	CLIP
13		NPR	7D-7233	2	CLIP
14	1	NPR	7M-8485	1	SEAL-O-RING
15	2	NPR	8T-1117	2	CLAMP-HOSE
16		NPR	8T-4121	9	WASHER-HARD (11X21X2.5-MM THK)
17		NPR M	8T-4133	4	NUT (M10X1.5-THD)
18		NPR M	8T-4136	5	BOLT (M10X1.5X25-MM)
19		NPR M	8T-4196	2	BOLT (M10X1.5X35-MM)
20		NPR M	8T-4198	2	BOLT (M10X1.5X100-MM)
21		NPR	8T-7934	4	WASHER-HARD (11X21X5-MM THK)
22		NPR	9M-8406	2	CLIP

23	I	NPR	9Y-9236	1	GAUGE-SIGHT (EXPANSION TANK)
24	X	NPR E	9X-2133		HOSE (69-CM)
25	X	NPR E	5P-1251		HOSE (152-CM)
26		NPR E	6V-8523		HOSE (234-CM)

Key:

E - ORDER BY THE CENTIMETER

M - METRIC PART

SMCS Codes		
1377		

Copyright 1993 - 2009 Caterpillar Inc.
All Rights Reserved.
Private Network For SIS Licensees.

Fri Jun 26 10:54:30 PDT 2009

JOHNSON MACHINERY

CAT Service Information System

Shutdown SIS

Previous Screen

Product: NO EQUIPMENT SELECTED
 Model: NO EQUIPMENT SELECTED
 Configuration: NO EQUIPMENT SELECTED

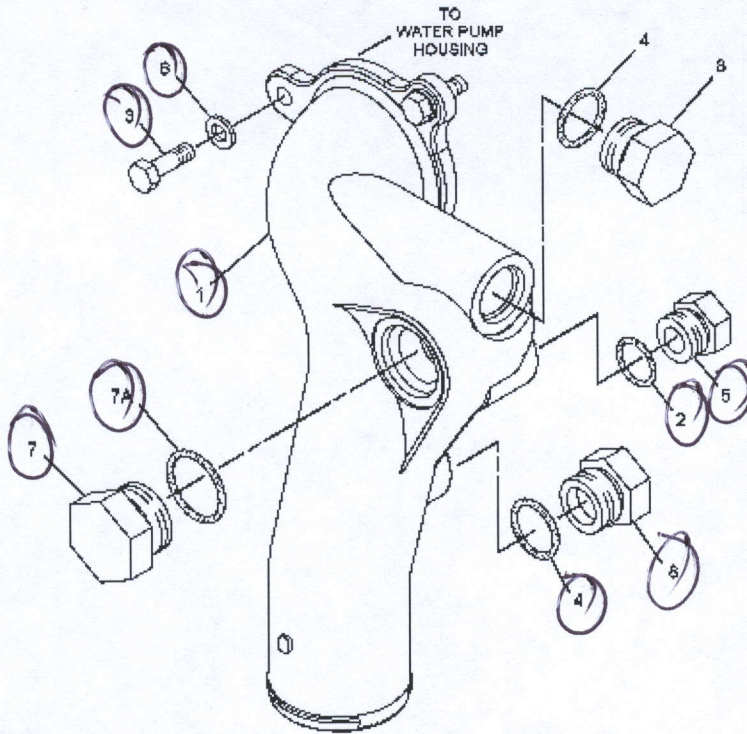

GRAPHIC #1
 g01435446

C13 Industrial Engine

Media Number - SEBP4130-29 | Publication Date - 01/03/2009 | Date Updated - 26/03/2009

i02854922

238-8720 LINES GP-WATER -INLET ELBOW AN ATTACHMENT

ENTIRE GROUP

Ref.	Qty.	NPR Note	Part No.	Part Name
Grp		<u>NPR</u>	238-8720	LINES GP-WATER -INLET ELBOW

INDIVIDUAL PARTS

Ref.	Qty.	NPR Note	Part No.	Req. Qty.	Part Name
1	1	<u>NPR</u>	229-6231	1	ELBOW-WATER PUMP
2	1	<u>NPR</u>	6V-3251	1	SEAL-O-RING
3	3	<u>NPR M</u>	6V-3940	3	BOLT (M8X1.25X25-MM)
4	1	<u>NPR</u>	6V-5063	2	SEAL-O-RING

5	1	NPR	9S-4190	1	PLUG-O-RING (7/8-14-2A THD)
6	3	NPR	9M-1974	3	WASHER-HARD (8.8X16X2-MM THK)
7	1	NPR	164-4180	1	PLUG AS
	1	NPR	9S-4181	1	PLUG-O-RING (1 5/16-12-2A THD)
7A	1	NPR	7M-8485	1	SEAL-O-RING
8	1	NPR	9S-4183	2	PLUG-O-RING (1 1/16-12-2A THD)

Key:

M - METRIC PART

SMCS Codes		
1393	1355	1380

Copyright 1993 - 2009 Caterpillar Inc.
 All Rights Reserved.
 Private Network For SIS Licensees.

Fri Jun 26 10:57:52 PDT 2009

Previous Screen

Product: NO EQUIPMENT SELECTED
Model: NO EQUIPMENT SELECTED
Configuration: NO EQUIPMENT SELECTED

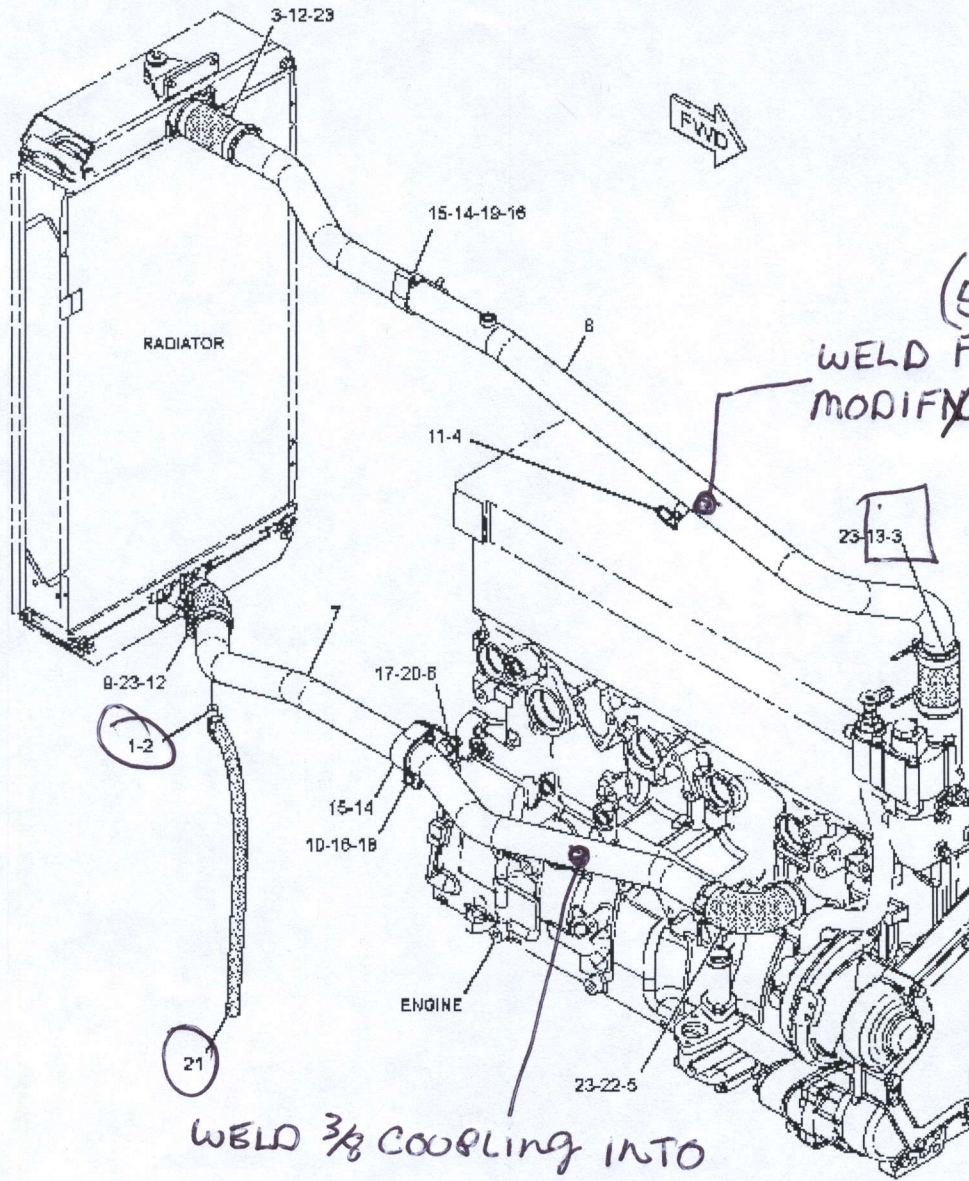

(5P8874)
WELD FITTING INTO 16H TUBE
MODIFIED TO FIT

WELD 3/8 COUPLING INTO
BOTTOM MODIFIED TUBE

GRAPHIC #1
g01523873

16M Motor Grader, Powered By C13 Engine
Media Number - SEBP4108-21 | Publication Date - 01/02/2009 | Date
Updated - 18/02/2009

i02975784

249-7325 LINES GP-WATER
S/N B9H1-UP
PART OF 285-0103 COMMON AR

ENTIRE GROUP

Ref. Qty.	NPR Note	Part No.	Part Name
Grp	NPR	249-7325	LINES GP-WATER

INDIVIDUAL PARTS

Ref. Qty.	NPR Note	Part No.	Req. Qty.	Part Name
1	NPR	5D-1026	1	CLAMP-HOSE
2	NPR	8F-8151	1	VALVE-SHUTOFF
3	NPR E	5P-1262		HOSE (16-CM EACH) X7
4	NPR	157-0670	1	CAP-DUST
5	NPR	163-2919	1	HOSE
6	NPR	255-5415	1	BRACKET AS
7	NPR	260-6612	1	TUBE AS
8	NPR	260-6613	1	TUBE AS
9	NPR	291-6388	1	HOSE
10	NPR	138-7500	1	SPACER (11X25X50-MM THK)
11	NPR	154-9025	1	VALVE-FLUID SAMPLING (ENGINE COOLANT)
12	NPR	208-6054	4	CLAMP
13	NPR	209-4575	2	CLAMP
14	NPR	6V-1581	2	CLIP (SLOT)
15	NPR	6V-1582	2	CLIP (TAB)
16	NPR	8T-4121	2	WASHER-HARD (11X21X2.5-MM THK)
17	NPR	8T-4123	2	WASHER (22X35X3.5-MM THK)
18	NPR M	8T-4172	1	BOLT (M10X1.5X80-MM)
19	NPR M	8T-4195	1	BOLT (M10X1.5X30-MM)
20	NPR M	8T-4780	2	BOLT (M20X2.5X30-MM)
21	NPR E	5P-0767		HOSE (71-CM)
22	NPR	209-4577	2	CLAMP
23	NPR	8C-0620	8	PROTECTOR-THREAD

Key:

E - ORDER BY THE CENTIMETER
M - METRIC PART

SMCS Codes		
1393	1380	1355

Copyright 1993 - 2009 Caterpillar Inc.
All Rights Reserved.
Private Network For SIS Licensees.

Fri Jun 26 10:35:23 PDT 2009

Previous Screen

Product: NO EQUIPMENT SELECTED
Model: NO EQUIPMENT SELECTED
Configuration: NO EQUIPMENT SELECTED

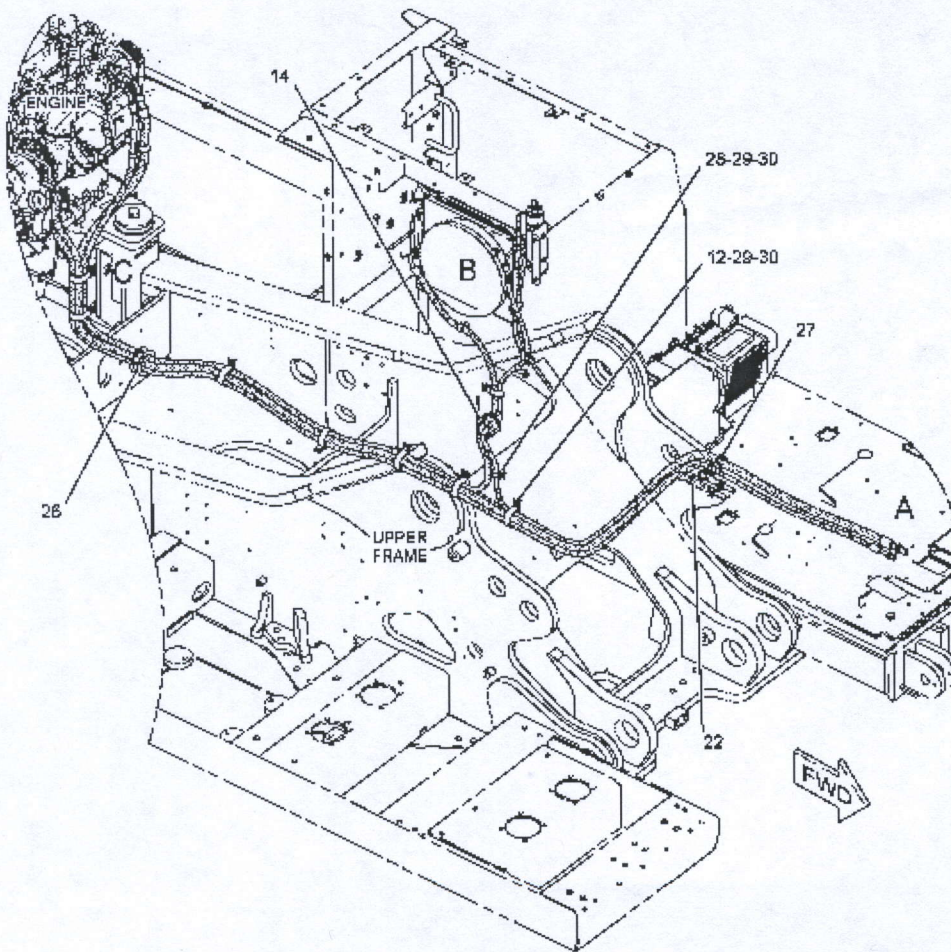

REFER TO ALL ILLUSTRATIONS OF THIS GROUP FOR AUXILIARY VIEWS

GRAPHIC #1
g01113072

SEE PAGE 2

INDIVIDUAL PARTS

Ref.	Qty.	NPR Note	GR#	Part No.	Req. Qty.	Part Name
1		NPR	2	6P-8855	2	TUBE
2		NPR	2	176-1902	1	RECEIVER-REFRIGERANT DRYER
3		NPR	2	189-3434	1	ELBOW
4		NPR	2	229-9121	1	HOSE AS
		NPR	2	121-7137	2	SEAL-O-RING
		NPR	2	245-7850	1	PLUG
5		NPR	2	229-9124	1	HOSE AS
		NPR	2	121-7138	2	SEAL-O-RING
6		NPR	2	229-9129	1	BRACKET AS
7	2	NPR	2	235-9014	4	CLAMP-HOSE
8		NPR	2	240-4995	1	BRACKET AS
9		NPR	2	245-7918	1	ADAPTER
10		NPR	2	260-0140	1	HOSE AS
		NPR	2	121-7138	1	SEAL-O-RING
11		NPR	2	260-0141	1	HOSE AS
		NPR	2	121-7136	1	SEAL-O-RING
		NPR	2	245-7851	1	PLUG
12		NPR	1,2	104-3173	7	CLIP
13		NPR	2	121-7098	1	BRACKET AS
		NPR M	2	8T-4138	2	BOLT (M6X1X20-MM)
		NPR	2	9X-8256	2	WASHER (6.6X12X2-MM THK)
14		NPR	1	133-4419	1	GROMMET
15	2	NPR	2	2M-9780	2	SEAL-O-RING
16		NPR	2	3K-0360	3	SEAL-O-RING
17		NPR	2	5K-5338	1	CLIP
18		NPR	2	5P-7854	1	CLIP
19		NPR	2	6D-1641	1	CLIP
20		NPR	2	6D-4244	2	CLIP
21		NPR	2	6K-8178	1	CLIP
22		NPR	1	6P-4467	2	GROMMET
23	2	NPR	2	6V-7238	2	VALVE-SHUTOFF (ENGINE COOLANT)
24		NPR M	2	6V-7357	2	BOLT (M6X1X25-MM)
25	1	NPR	2	6V-7420	1	ADAPTER
26		NPR	1	7Y-8165	1	GROMMET
27		NPR	1	7Y-8169	2	GROMMET
28		NPR	1,2	8M-2773	2	CLIP
29		NPR	1,2	8T-4121	16	WASHER-HARD (11X21X2.5-MM THK)

30	<input type="checkbox"/>	NPR M	1,2	8T-4137	16	BOLT (M10X1.5X20-MM)
31	<input type="checkbox"/>	NPR M	2	8T-4200	2	BOLT (M8X1.25X16-MM)
32	<input type="checkbox"/>	NPR	2	8T-4224	2	WASHER-HARD (8.8X16X2-MM THK)
33	<input type="checkbox"/>	NPR M	2	8T-4971	2	BOLT (M6X1X30-MM)
34	<input type="checkbox"/>	NPR	2	9X-8256	4	WASHER (6.6X12X2-MM THK)
35	<input type="checkbox"/>	NPR E	2	5P-0767		HOSE (270=CM) Long ENOUGH TO YOUR
35A	<input type="checkbox"/>	NPR E	2	5P-0767		HOSE (260=CM) MACHINE

Key:

E - ORDER BY THE CENTIMETER
M - METRIC PART

SMCS Codes		
1808		

Copyright 1993 - 2009 Caterpillar Inc.
All Rights Reserved.
Private Network For SIS Licensees.

Fri Jun 26 11:34:58 PDT 2009

JOHNSON MACHINERY

CAT Service Information System

Shutdown SIS

Previous Screen

Product: NO EQUIPMENT SELECTED
 Model: NO EQUIPMENT SELECTED
 Configuration: NO EQUIPMENT SELECTED

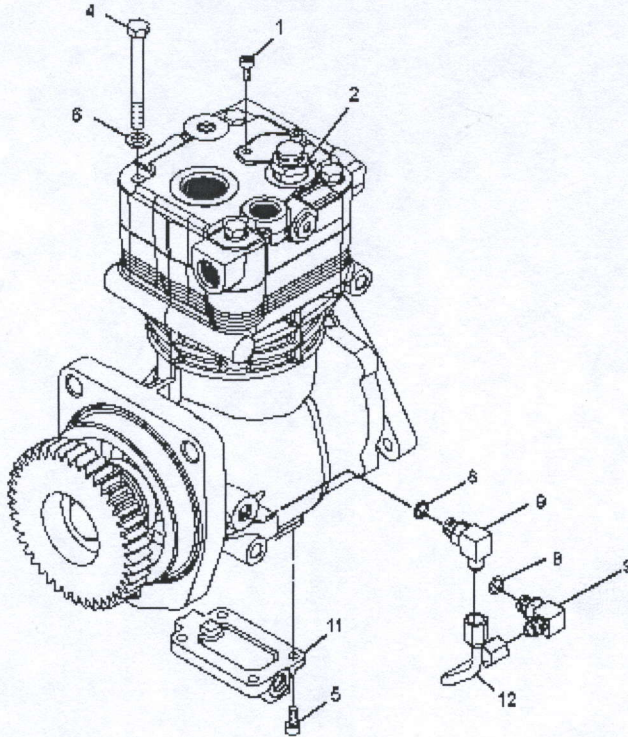

GRAPHIC #1
 g01383458

C13 On-highway Engine

Media Number - SEBP4356-30 | Publication Date - 01/03/2009 | Date Updated - 27/03/2009

i03439900

255-4160 AIR COMPRESSOR GP
PART OF 222-2900 AIR COMPRESSOR GP
 Type 2
AN ATTACHMENT

ALL PARTS THIS PAGE

ENTIRE GROUP

Ref.	Qty.	NPR Note	Part No.	Part Name
Grp	X	NPR	255-4160	AIR COMPRESSOR GP
R		NPR	0R-1623	COMPRESSOR GP -B

INDIVIDUAL PARTS

Ref.	Qty.	NPR Note	Part No.	Req. Qty.	Part Name
1		NPR M	099-2374	2	BOLT-SOCKET HEAD (M5X0.8X12-MM)
2		NPR	225-5222	1	VALVE AS-PRESSURE RELIEF

				(AIR COMPRESSOR)
		NPR	2M-9780	1 SEAL-O-RING
4		NPR M	6V-5221	4 BOLT (M8X1.25X80-MM)
5		NPR	255-0696	4 BOLT-SOCKET HEAD (M6X1X14-MM)
6		NPR	9M-1974	4 WASHER-HARD (8.8X16X2-MM THK)
8		NPR	3J-7354	2 SEAL-O-RING
9		NPR	030-7946	2 ELBOW
11		NPR	255-4161	1 COVER AS
12		NPR	254-3364	1 TUBE AS

		NPR	217-5232	1 AVAILABLE GASKET KIT(S): KIT-GASKET (AIR COMPRESSOR) (INCLUDES INLET REED VALVE/GASKET AND CYLINDER HEAD GASKET)
		NPR	260-6822	1 KIT-UNLOADER (AIR COMPRESSOR) (INCLUDES UNLOADER CAP GASKET, ESS BALANCE PISTON, ESS SPRING, ESS PISTON, AND O-RINGS)
		NPR	260-6821	1 KIT-SEAL (INCLUDES O-RING-END COVER, CRANKCASE COVER GASKETS, REAR COVER GASKET, AND INSTRUCTION SHEET)
		NPR	329-0223	1 KIT-HEAD (AIR COMPRESSOR) (INCLUDES CYLINDER HEAD ASSEMBLY, INLET REED/GASKET, CYLINDER HEAD BOLTS & INSTRUCTION SHEET)

Key:

M - METRIC PART

SMCS Codes		
1803		

JOHNSON MACHINERY

CAT Service Information System

Shutdown SIS

Previous Screen

< Product: TRUCK ENGINE
Model: C13 TRUCK ENGINE KCB
Configuration: C13 On-highway Engine KCB00001-UP

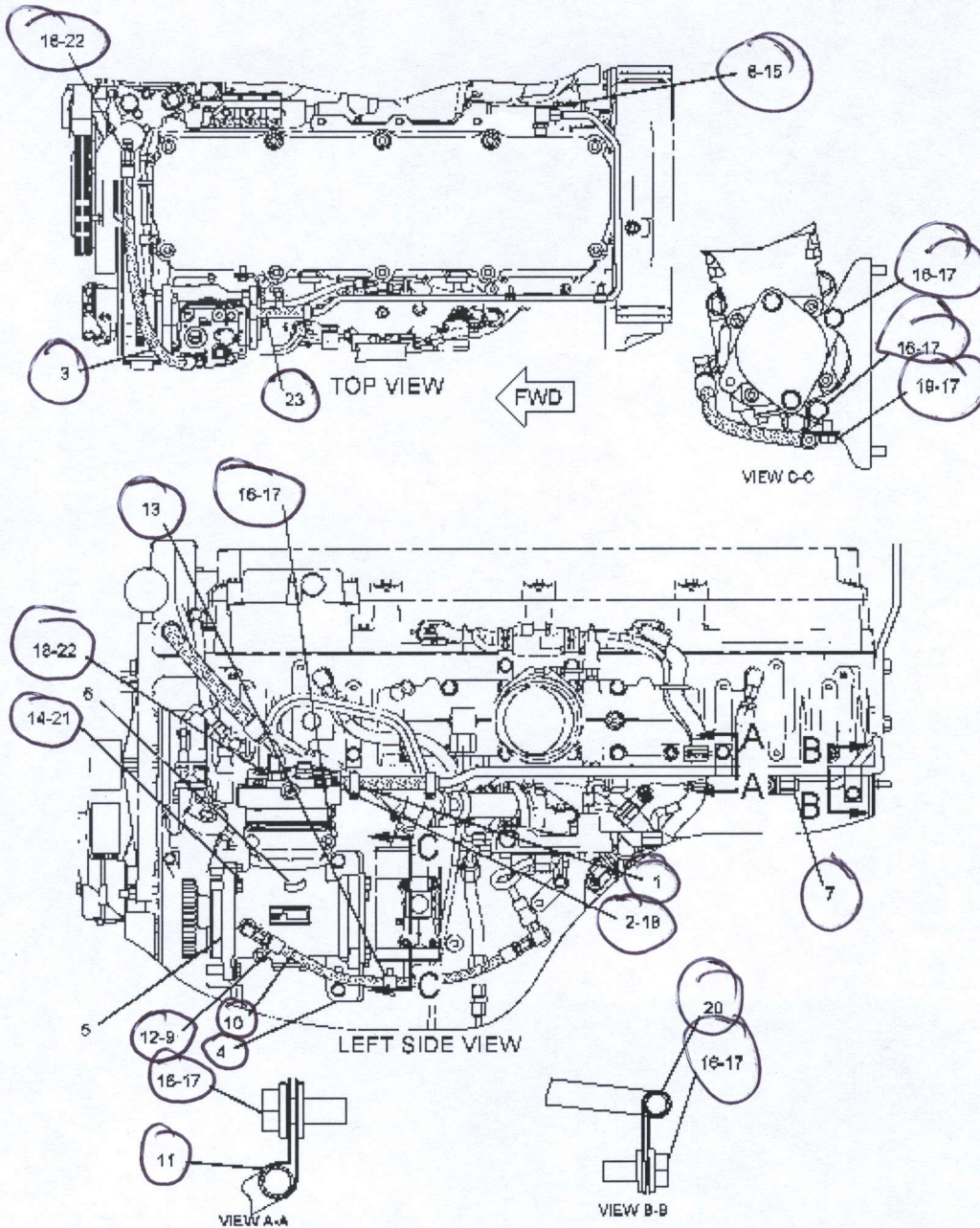

GRAPHIC #1
g01056292

USED ALL PARTS THIS PAGE

C13 On-highway Engine
Media Number - SEBP3735-37 | Publication Date - 01/03/2009 | Date
Updated - 26/03/2009

i02037049

222-2900 AIR COMPRESSOR GP

S/N KCB1-8316

**PROVIDES AIR COMPRESSOR WITHOUT GOVERNOR
FOR USE WITH AIR COMPRESSOR AIR LINES
ALSO AN ATTACHMENT**

ENTIRE GROUP

Ref. Qty.	NPR Note	Part No.	Part Name
Grp	<u>NPR</u>	222-2900	AIR COMPRESSOR GP

INDIVIDUAL PARTS

Ref. Qty.	NPR Note	Part No.	Req. Qty.	Part Name
1	<u>NPR</u>	5D-1026	2	CLAMP-HOSE
2	<u>NPR</u>	034-3679	1	FITTING
3	<u>NPR I</u>	222-2887	1	HOSE AS
4	<u>NPR</u>	222-2889	1	BRACKET
5	<u>NPR</u>	223-3505	1	SEAL
6	<u>NPR Y</u>	222-2900	1	AIR COMPRESSOR GP 2554160
7	<u>NPR</u>	230-3819	1	TUBE AS
8	<u>NPR</u>	005-4173	1	ELBOW
9	<u>NPR</u>	030-7946	1	ELBOW
10	<u>NPR I</u>	153-4812	1	HOSE AS
11	<u>NPR</u>	1B-3057	1	CLIP
12	<u>NPR</u>	3J-7354	1	SEAL-O-RING
13	<u>NPR</u>	4K-8864	1	CLIP
14	<u>NPR</u>	5P-8245	3	WASHER-HARD (13.5X25.5X3-MM THK)
15	<u>NPR</u>	6V-3251	1	SEAL-O-RING
16	<u>NPR M</u>	6V-4248	6	BOLT (M10X1.5X25-MM)
17	<u>NPR</u>	6V-5839	9	WASHER (11X21X2.5-MM THK)
18	<u>NPR</u>	6V-6609	3	SEAL-O-RING
19	<u>NPR M</u>	6V-8212	1	BOLT (M10X1.5X16-MM)
20	<u>NPR</u>	7B-1598	1	CLIP
21	<u>NPR M</u>	6V-8197	3	BOLT (M12X1.75X40-MM)
22	<u>NPR</u>	8M-0505	2	CONNECTOR
23	<u>NPR E</u>	5P-1505		HOSE (14-CM)

Key:

E - ORDER BY THE CENTIMETER
I - REFER TO HYDRAULIC INFORMATION SYSTEM
M - METRIC PART
Y - SEPARATE ILLUSTRATION

SMCS Codes		
1803		

Copyright 1993 - 2009 Caterpillar Inc.
All Rights Reserved.
Private Network For SIS Licensees.

Fri Jun 26 13:49:29 PDT 2009

JOHNSON MACHINERY



Service Information System

Shutdown SIS

Previous Screen

Product: NO EQUIPMENT SELECTED
 Model: NO EQUIPMENT SELECTED
 Configuration: NO EQUIPMENT SELECTED

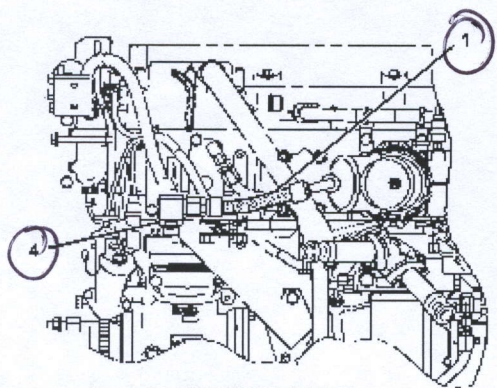

LEFT SIDE VIEW

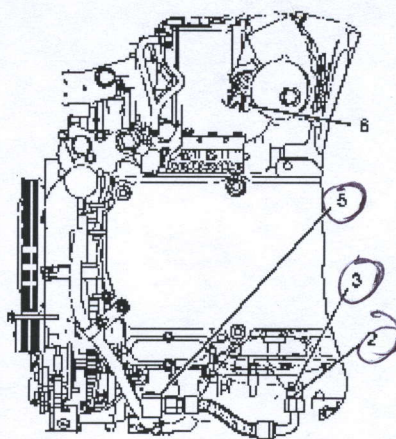

FWD TOP VIEW

GRAPHIC #1
 g01380640

C13 On-highway Engine

Media Number - SEBP3735-37 | Publication Date - 01/03/2009 | Date Updated - 26/03/2009

i02756772

246-0014 LINES GP-AIR COMPRESSOR

S/N KCB4642-UP

FOR USE WITH A DISCHARGE LINE UNLOADING SYSTEM FOR THE COMPRESSOR TO MAINTAIN EMISSIONS COMPLIANCE

CANNOT BE USED WITH 252-5096



ALSO AN ATTACHMENT

ENTIRE GROUP

Ref. Qty.	NPR Note	Part No.	Part Name
Grp <input type="text"/>	NPR	246-0014	LINES GP-AIR COMPRESSOR

INDIVIDUAL PARTS

Ref. Qty.	NPR Note	Part No.	Req. Qty.	Part Name
1	<input type="text"/> NPR I	247-6491	1	HOSE AS
2	<input type="text"/> NPR	2R-6276	1	CONNECTOR

3		NPR	3D-2824	1	SEAL-O-RING
4		NPR	6V-1903	1	SEAL-O-RING
5		NPR	8K-2377	1	ELBOW-FLARED
6		NPR	148-8409	1	PLUG AS
		NPR	3D-2824	1	SEAL-O-RING
		NPR	9S-8008	1	PLUG-O-RING

Key:

I - REFER TO HYDRAULIC INFORMATION SYSTEM

SMCS Codes		
1803	5502	

Copyright 1993 - 2009 Caterpillar Inc.
 All Rights Reserved.
 Private Network For SIS Licensees.

Fri Jun 26 10:58:56 PDT 2009

JOHNSON MACHINERY



Service Information System

Shutdown SIS

Previous Screen

< Product: NO EQUIPMENT SELECTED
Model: NO EQUIPMENT SELECTED
Configuration: NO EQUIPMENT SELECTED

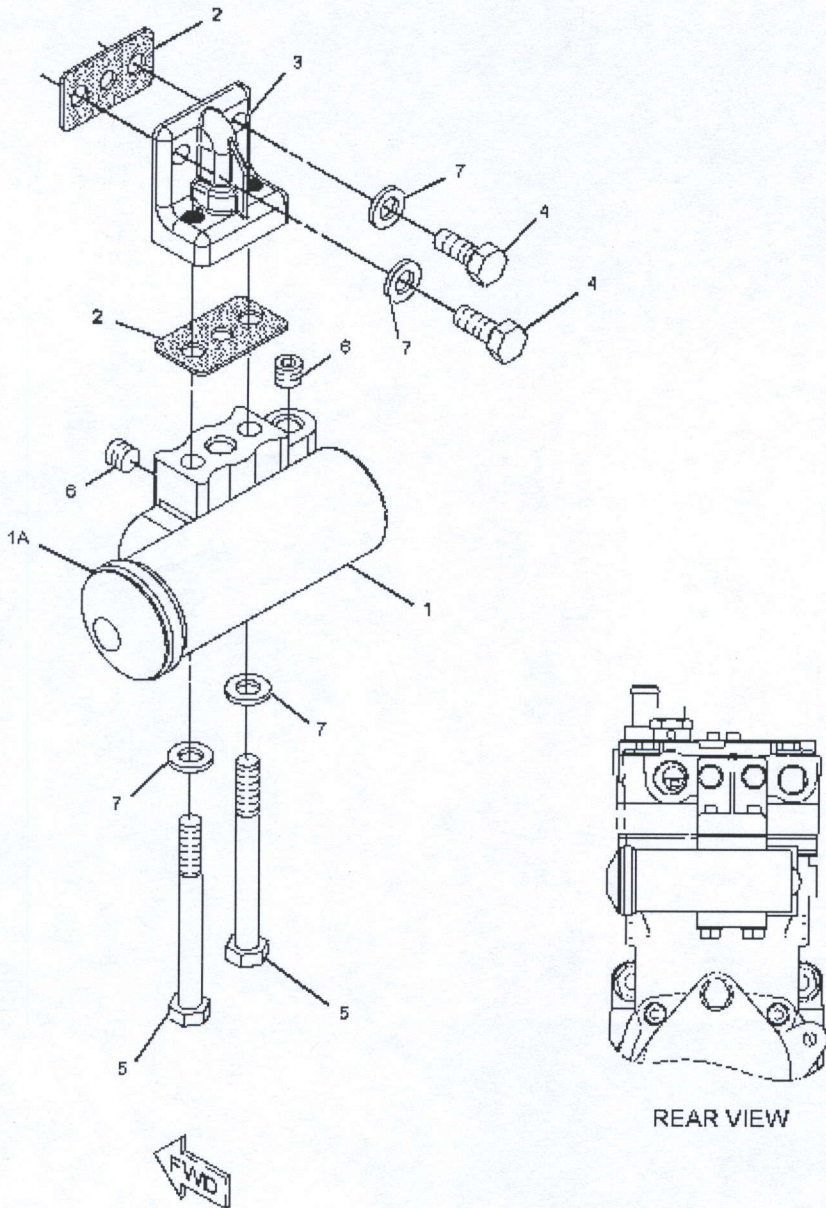

REAR VIEW

GRAPHIC #1
g01068320

USED ALL PARTS THIS PAGE

C13 Industrial Engine

Media Number - SEBP4130-29 | Publication Date - 01/03/2009 | Date
Updated - 26/03/2009

224-4501 GOVERNOR GP-AIR COMPRESSOR
AN ATTACHMENT

i02250770

ENTIRE GROUP

Ref.	Qty.	NPR Note	Part No.	Part Name
Grp	<input type="text"/>	NPR	224-4501	GOVERNOR GP-AIR COMPRESSOR

INDIVIDUAL PARTS

Ref.	Qty.	NPR Note	Part No.	Req. Qty.	Part Name
1	<input type="text"/>	NPR Y	4N-9680	1	GOVERNOR GP-AIR COMPRESSOR
1A	<input type="text"/>	NPR	2S-2923	1	COVER
	<input type="text"/>	NPR	9M-0402	1	KIT-GOVERNOR OVERHAUL (AIR COMPRESSOR) (INCLUDES GROMMETS, FILTERS, SPRING, VALVE, COVER, RING, AND GASKET)
2	<input type="text"/>	NPR	6L-1883	2	GASKET
3	<input type="text"/>	NPR	179-4787	1	ADAPTER
4	<input type="text"/>	NPR M	6V-5217	2	BOLT (M8X1.25X20-MM)
5	<input type="text"/>	NPR M	6V-5221	2	BOLT (M8X1.25X80-MM)
6	<input type="text"/>	NPR	8T-6757	3	PLUG-PIPE
7	<input type="text"/>	NPR	9M-1974	4	WASHER-HARD (8.8X16X2-MM THK)

Key:

M - METRIC PART

SMCS Codes		
1804		

Previous Screen

Product: NO EQUIPMENT SELECTED
Model: NO EQUIPMENT SELECTED
Configuration: NO EQUIPMENT SELECTED

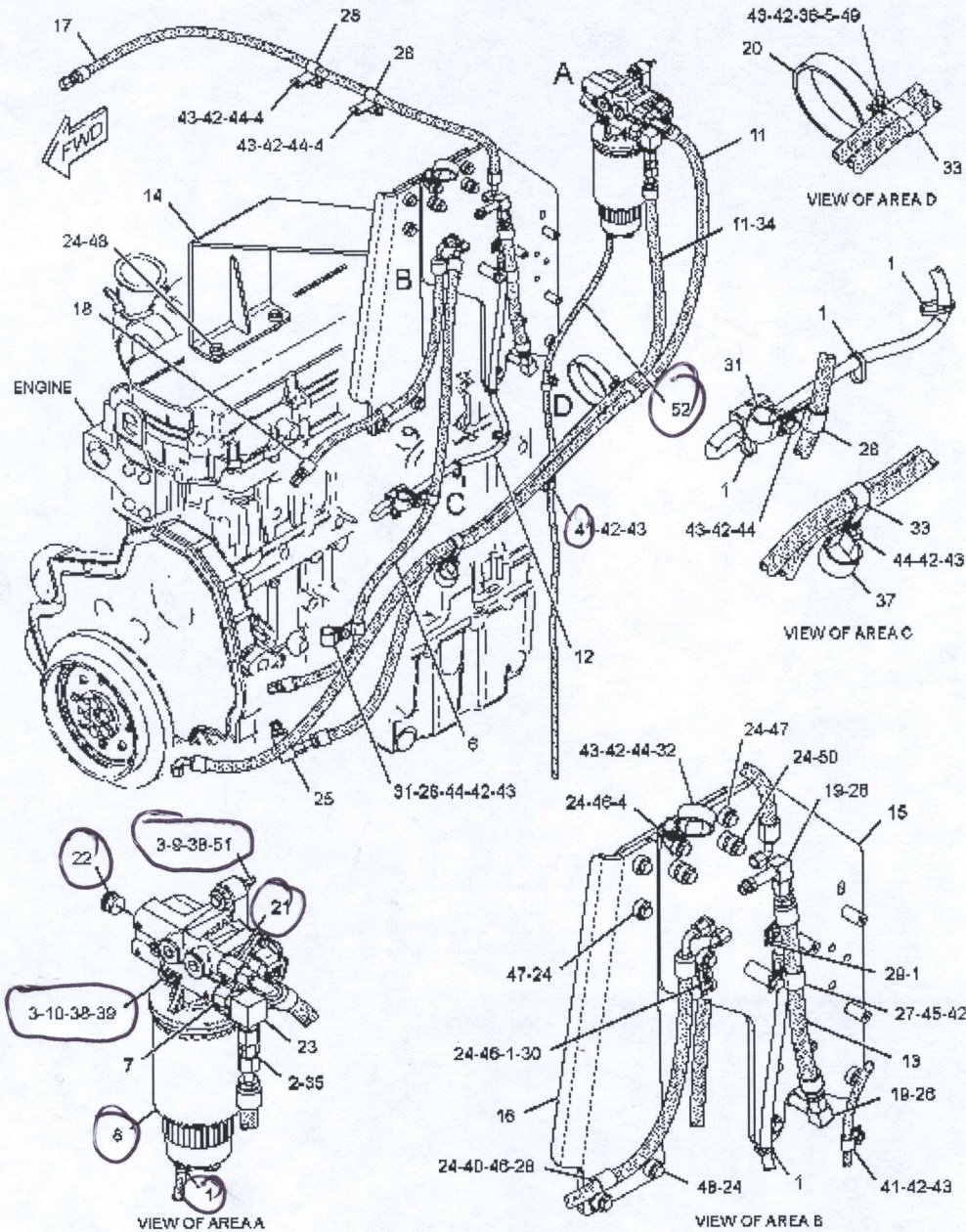

GRAPHIC #1
g01505974

16M Motor Grader, Powered By C13 Engine
Media Number - SEBP4108-21 | Publication Date - 01/02/2009 | Date
Updated - 18/02/2009

i02770882

249-7324 PUMP GP-FUEL PRIMING
S/N B9H1-230
PART OF 285-0103 COMMON AR

ENTIRE GROUP

Ref.	Qty.	NPR Note	Part No.	Part Name
Grp	<input type="text"/>	NPR	249-7324	PUMP GP-FUEL PRIMING

INDIVIDUAL PARTS

Ref.	Qty.	NPR Note	Part No.	Req. Qty.	Part Name
1	1	NPR	3S-2093	7	STRAP-CABLE
2	<input type="text"/>	NPR	6E-5444	1	VALVE GP-CHECK
3	6	NPR	8T-9655	6	MOUNT-ISOLATION
4	<input type="text"/>	NPR	9L-1566	3	SUPPORT
5	<input type="text"/>	NPR	9R-5008	1	SPACER (11X20X6-MM THK)
6	<input type="text"/>	NPR I	136-9141	1	HOSE AS-FUEL
7	<input type="text"/>	NPR	161-9916	1	ADAPTER AS
	1	NPR	6V-7420	1	ADAPTER
	1	NPR	2M-9780	1	SEAL-O-RING
8	1	NPR Y	190-8977	1	PUMP GP-FUEL PRM & WATER SEP (PRIMARY FUEL FILTER)
9	1	NPR	191-1782	1	SPACER (8.5X12.7X38.2-MM THK)
10	2	NPR	191-1783	2	SPACER (8.5X12.7X87.3-MM THK)
11	<input type="text"/>	NPR I	236-1076	2	HOSE AS
12	<input type="text"/>	NPR	266-9363	1	HARNES AS-SENSOR
	<input type="text"/>	NPR	102-8806	1	KIT-RECEPTACLE (8-PIN) (INCLUDES RECEPTACLE AS & WEDGE)
	<input type="text"/>	NPR	155-2265	1	KIT-CONNECTING PLUG (8- PIN) (INCLUDES PLUG AS, WEDGE, & INTERFACE SEAL)
13	<input type="text"/>	NPR I	271-3844	1	HOSE AS
14	<input type="text"/>	NPR	283-6906	1	BRACKET AS
15	<input type="text"/>	NPR	283-6910	1	BRACKET AS
16	<input type="text"/>	NPR	283-9806	1	BRACKET
17	<input type="text"/>	NPR I	284-9036	1	HOSE AS
18	<input type="text"/>	NPR I	285-2237	1	HOSE AS
19	<input type="text"/>	NPR	030-8276	2	ELBOW-FLARED
20	<input type="text"/>	NPR	133-9229	1	CLIP
21	<input type="text"/>	NPR	148-8343	1	CONNECTOR AS
	1	NPR	9X-6550	1	CONNECTOR
	1	NPR	2M-9780	1	SEAL-O-RING
	1	NPR	6V-8397	1	SEAL-O-RING

22		NPR	164-5619	2	PLUG AS (EACH INCLUDES)
		NPR	9S-8006	1	PLUG-O-RING
		NPR	2M-9780	1	SEAL-O-RING
23		NPR	171-6728	1	ELBOW AS
		NPR	3K-0360	1	SEAL-O-RING
		NPR	8T-0249	1	ELBOW
24		NPR	198-4777	17	WASHER-HARD (11X25X10-MM THK)
25		NPR	268-1605	1	ELBOW AS
		NPR	8T-1686	1	ELBOW
		NPR	228-7090	1	SEAL-O-RING
		NPR	238-5080	1	SEAL-O-RING
26		NPR	3J-1907	2	SEAL-O-RING
27		NPR	3S-8665	1	CLIP
28		NPR	4D-7735	5	CLIP
29		NPR	4P-7428	1	CLIP
30		NPR	4P-7581	1	CLIP
31		NPR	4S-1962	2	CLIP
32		NPR	5P-2369	1	CLIP
33		NPR	6D-4247	2	CLIP
34		NPR	6V-8397	1	SEAL-O-RING
35		NPR	6V-8398	2	SEAL-O-RING
36		NPR	6W-7636	1	SPACER (11.13X19.05X30-MM THK)
37		NPR	7D-7233	1	CLIP
38	3	NPR	7X-0579	3	WASHER-HARD (8.8X25.5X2-MM THK)
39	2	NPR M	7X-2539	2	BOLT (M8X1.25X110-MM)
40		NPR	7X-7729	1	WASHER (11X25X3-MM THK)
41	2	NPR	8M-2770	2	CLIP
42		NPR	8T-4121	18	WASHER-HARD (11X21X2.5-MM THK)
43		NPR M	8T-4133	9	NUT (M10X1.5-THD)
44		NPR M	8T-4136	6	BOLT (M10X1.5X25-MM)
45		NPR M	8T-4137	1	BOLT (M10X1.5X20-MM)
46		NPR M	8T-4182	3	BOLT (M10X1.5X45-MM)
47		NPR M	8T-4186	4	BOLT (M10X1.5X40-MM)
48		NPR M	8T-4196	6	BOLT (M10X1.5X35-MM)
49		NPR M	8T-5005	1	BOLT (M10X1.5X70-MM)
50		NPR M	8T-6466	2	BOLT (M10X1.5X60-MM)
51		NPR M	8T-6869	1	BOLT (M8X1.25X60-MM)
52	X	NPR E	8C-6959		HOSE (147-CM)

Key:

- E - ORDER BY THE CENTIMETER
- I - REFER TO HYDRAULIC INFORMATION SYSTEM
- M - METRIC PART
- Y - SEPARATE ILLUSTRATION

SMCS Codes		
1258		

Copyright 1993 - 2009 Caterpillar Inc.
All Rights Reserved.
Private Network For SIS Licensees.

Fri Jun 26 11:31:14 PDT 2009

JOHNSON MACHINERY



Service Information System

Shutdown SIS

Previous Screen

◀ Product: NO EQUIPMENT SELECTED
Model: NO EQUIPMENT SELECTED
Configuration: NO EQUIPMENT SELECTED

GRAPHIC #1
g00906785

16H Motor Grader, Powered By 3196 Engine

Media Number - SEBP3329-42 | Publication Date - 01/02/2009 | Date
Updated - 12/02/2009

i02304901

**159-5935 CONTROL GP-GOVERNOR
S/N ATS1-UP
PART OF 162-5607 GENERAL AR**

ENTIRE GROUP

Ref. Qty.	NPR Note	Part No.	Part Name
Grp		159-5935	CONTROL GP-GOVERNOR

INDIVIDUAL PARTS

Ref. Qty.	NPR Note	Part No.	Req. Qty.	Part Name
1	<u>NPR</u>	1B-2578	1	NUT (3/8-16-THD)
2	<u>NPR</u>	141-6343	1	SPRING
3	<u>NPR</u>	4D-4064	1	ROD END (3/8-24-THD, FEMALE)
4	<u>NPR</u>	5P-9209	2	BEARING AS-NEEDLE
5	<u>NPR</u>	206-3599	1	LEVER
6	<u>NPR</u>	7F-0192	1	BOLT (3/8-16X2-IN)
7	<u>NPR</u>	7V-0446	1	CLIP
8	<u>NPR</u>	207-4927	1	PEDAL-GOVERNOR CONTROL
9	<u>NPR</u>	8X-3261	1	LEVER
10	<u>NPR</u>	116-5710	1	GROMMET
11	<u>NPR</u>	130-5300	1	CLIP
12	<u>NPR Y</u>	160-2443	1	SENSOR GP-POSITION (ROTARY) (THROTTLE)
13	<u>NPR</u>	161-7062	1	HOUSING
14	<u>NPR</u>	162-8218	1	GASKET
15	<u>NPR</u>	162-8219	1	COVER
16	<u>NPR</u>	168-8683	1	SHAFT
17	<u>NPR</u>	169-0921	1	ROD END-YOKE (3/8-24 LH-THD)
18	<u>NPR</u>	169-0922	1	ROD
19	<u>NPR</u>	172-0165	1	SHAFT
20	<u>NPR</u>	172-4211	1	SPACER (10.5X22X50.8-MM THK)
21	<u>NPR</u>	009-0008	1	SETSCREW-SOCKET (3/8-16X0.5-IN)
22	<u>NPR</u>	206-3600	1	LEVER (GOVERNOR CONTROL)
23	<u>NPR</u>	129-3173	1	BOLT-12 POINT HEAD (3/8-16X1.25-IN)
24	<u>NPR</u>	1B-0676	1	PIN
25	<u>NPR</u>	1B-8704	3	KEY-WOODRUFF
26	<u>NPR B</u>	2N-9421	2	SPRING-DISC
27	<u>NPR</u>	5P-1075	2	WASHER-HARD (10.2X22.5X3-MM THK)

28		NPR	5P-1076	1	WASHER-HARD (13.5X30X4-MM THK)
29		NPR	5S-7382	2	BOLT (3/8-16X1.375-IN)
30	2	NPR M	6V-2313	2	BOLT (M5X0.8X30-MM)
31		NPR	6V-8801	2	NUT (3/8-16-THD)
32	2	NPR	8T-0328	2	WASHER-HARD (5.5X10X1-MM THK)
33	3	NPR	8T-4121	3	WASHER-HARD (11X21X2.5-MM THK)
34	2	NPR M	8T-4133	2	NUT (M10X1.5-THD)
35	3	NPR M	8T-4136	3	BOLT (M10X1.5X25-MM)
36	2	NPR M	8T-4182	2	BOLT (M10X1.5X45-MM)
37		NPR	8T-4226	1	WASHER-PLATED (10.5X45X3-MM THK)
38		NPR	8T-5390	1	BOLT (3/8-16X3.5-IN)
39	1	NPR	6V-0894	1	SEAL-O-RING
40	1	NPR	2L-6267	1	LOCKNUT (3/8-24-THD)

Key:

B - USE AS REQUIRED
M - METRIC PART
Y - SEPARATE ILLUSTRATION

SMCS Codes		
1265	1276	

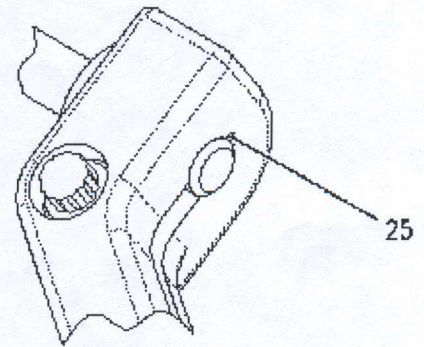
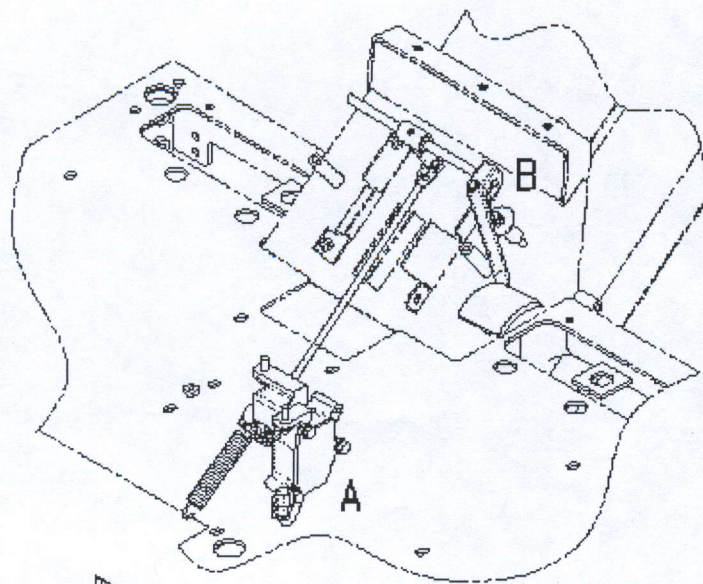

VIEW OF AREA B

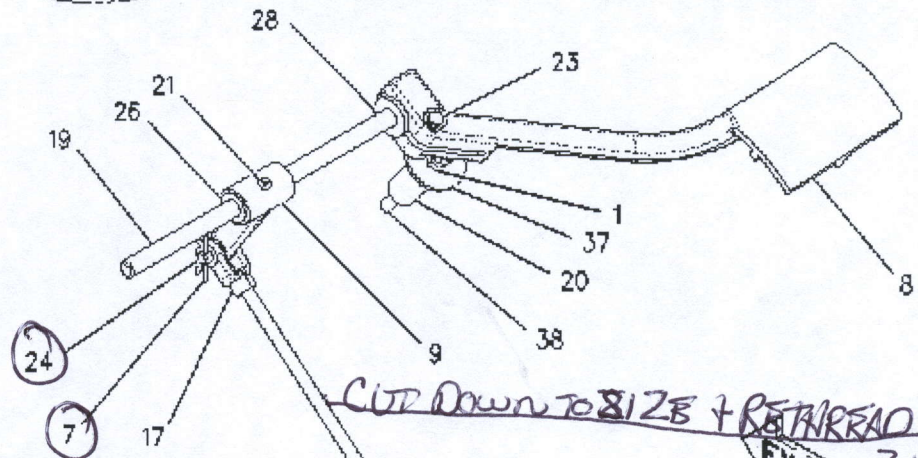

USE 1/2 F 6403 STD ROD END

CUT DOWN TO SIZE + RETREAD TO
3/8-24 NF
STD/NOT
LH THREAD

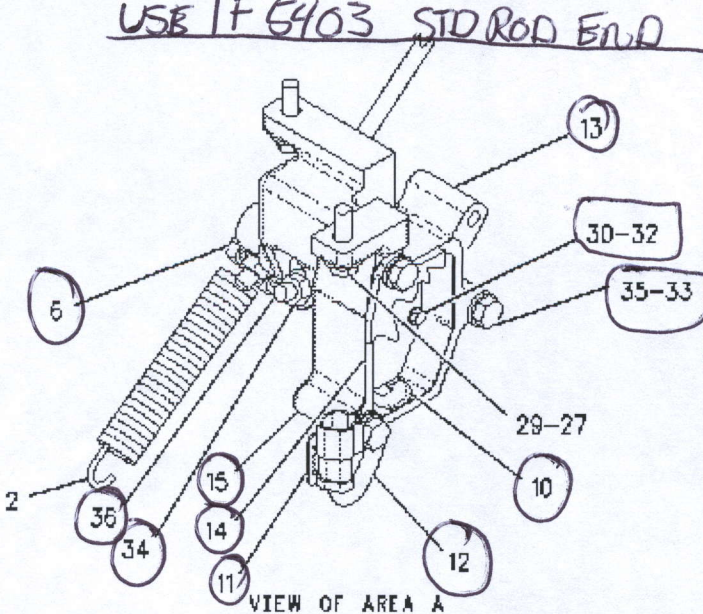

VIEW OF AREA A

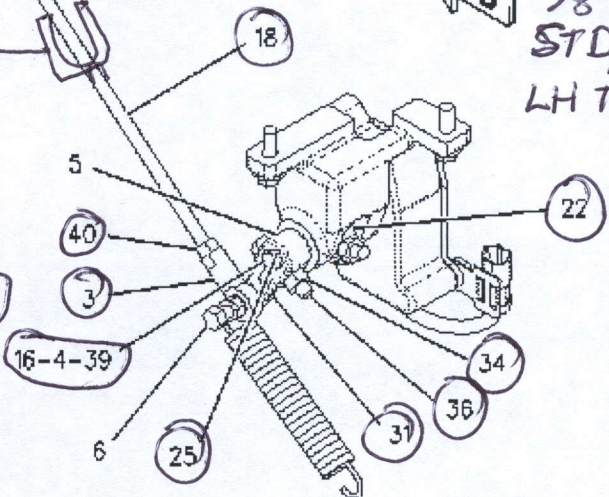

JOHNSON MACHINERY

CAT Service Information System

Shutdown SIS

Previous Screen

Product: NO EQUIPMENT SELECTED
 Model: NO EQUIPMENT SELECTED
 Configuration: NO EQUIPMENT SELECTED

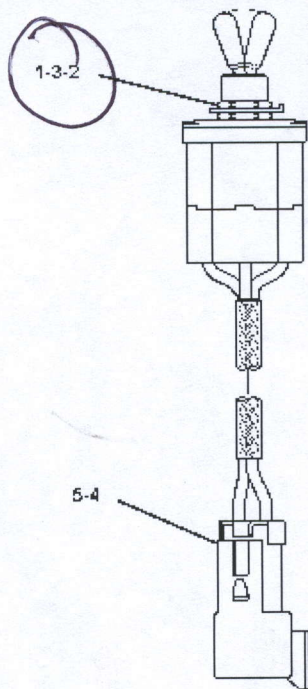

GRAPHIC #1
 g01874792

C13 Industrial Engine

Media Number - SEBP4130-29 | Publication Date - 01/03/2009 | Date
 Updated - 26/03/2009

i03546941

**165-5970 SWITCH GP-TOGGLE -FUEL PRIMING PUMP
 PART OF 298-4782 PUMP GP-FUEL PRM & PRIM FILTER
 AN ATTACHMENT**

ENTIRE GROUP

Ref.	Qty.	NPR Note	Part No.	Part Name
Grp	<input type="text"/>	NPR	165-5970	SWITCH GP-TOGGLE -FUEL PRIMING PUMP

INDIVIDUAL PARTS

Ref.	Qty.	NPR Note	Part No.	Req. Qty.	Part Name
1	<input type="text"/>	NPR	6T-3631	2	NUT-HEX (15/32-32-THD)
2	<input type="text"/>	NPR	6T-3632	1	LOCKWASHER
3	<input type="text"/>	NPR	6T-3633	1	RING-LOCKING

- | | | | | | |
|---|--|-----|----------|---|---|
| 4 | | NPR | 102-8803 | 1 | KIT-RECEPTACLE (3-PIN)
(INCLUDES RECEPTACLE AS &
WEDGE) |
| 5 | | NPR | 186-3735 | 3 | PIN-CONNECTOR (16-GA TO 18-GA) |

SMCS Codes		
7332		

Copyright 1993 - 2009 Caterpillar Inc.
 All Rights Reserved.
 Private Network For SIS Licensees.

Fri Jun 26 11:33:54 PDT 2009

Previous Screen

Product: NO EQUIPMENT SELECTED
 Model: NO EQUIPMENT SELECTED
 Configuration: NO EQUIPMENT SELECTED

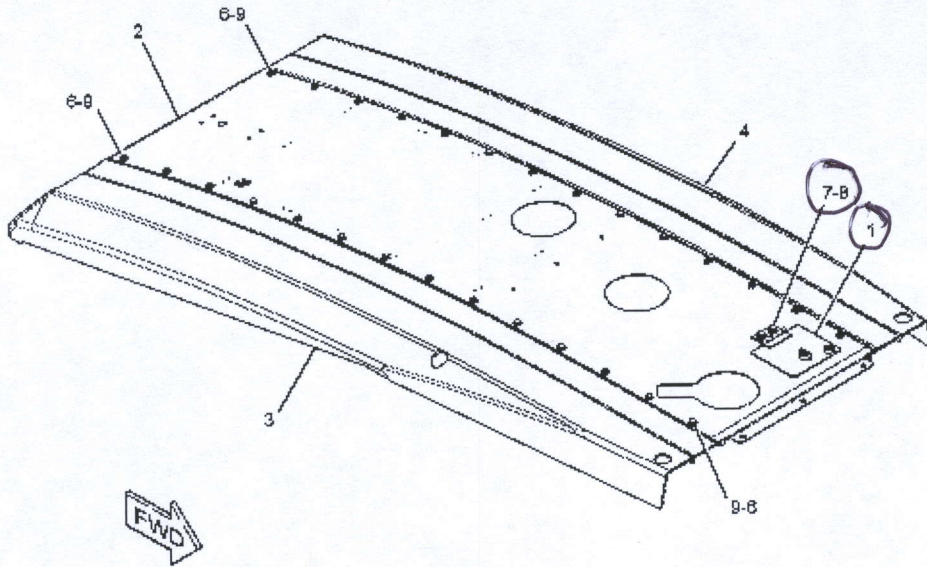

GRAPHIC #1
 g01382020

12M Motor Grader, Powered By C6.6 Engine
 Media Number - SEBP4979-11 | Publication Date - 01/02/2009 | Date
 Updated - 17/02/2009

i02793279

257-5096 HOOD GP
 S/N B9F1-UP
 PART OF 246-6031 ENCLOSURE GP-ENGINE

ENTIRE GROUP

Ref.	Qty.	NPR Note	Part No.	Part Name
Grp		NPR	257-5096	HOOD GP

INDIVIDUAL PARTS

Ref.	Qty.	NPR Note	Part No.	Req. Qty.	Part Name
1		NPR	201-9109	1	DOOR GP-ACCESS (BREAKERS, 24-VOLT OUTLET)
		NPR	219-6036	1	DOOR AS
		NPR	202-7670	1	LOCK GP-CYLINDER (DOOR)

				ACCESS)
	NPR	226-0295	1	LOCK AS
	NPR	233-4871	1	CAM
	NPR	203-6066	1	LATCH AS
2	NPR	257-4911	1	SHEET AS
	NPR M	6V-9632	4	NUT-WELD (M6X1-THD)
	NPR	7T-1099	3	LINK
	NPR M	8T-3490	5	NUT-WELD (M10X1.5-THD)
3	NPR	257-5107	1	CORNER AS (RH)
4	NPR	257-5108	1	CORNER AS (LH)
6	NPR	5P-4116	30	WASHER-HARD (8.8X20.5X2-MM THK)
7	2 NPR	7X-7729	2	WASHER (11X25X3-MM THK)
8	2 NPR M	8T-4137	2	BOLT (M10X1.5X20-MM)
9	NPR M	8T-4908	30	BOLT (M8X1.25X25-MM)

Key:

M - METRIC PART

SMCS Codes		
7251		

16H ENGINE HARNESS

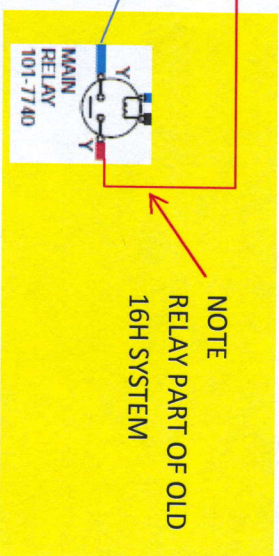
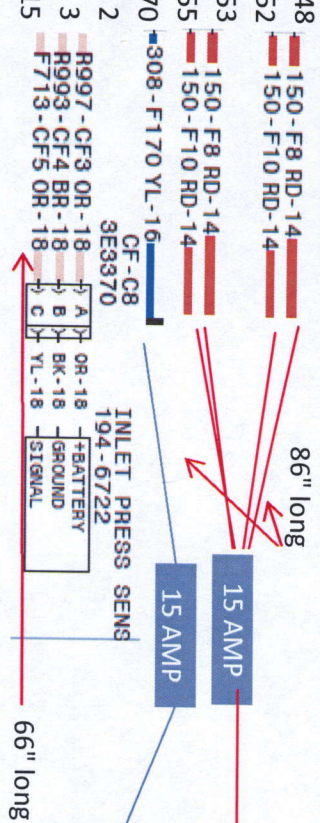
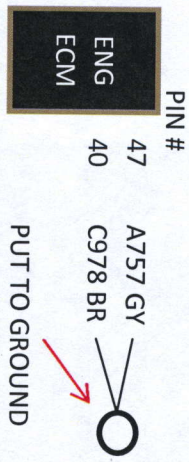
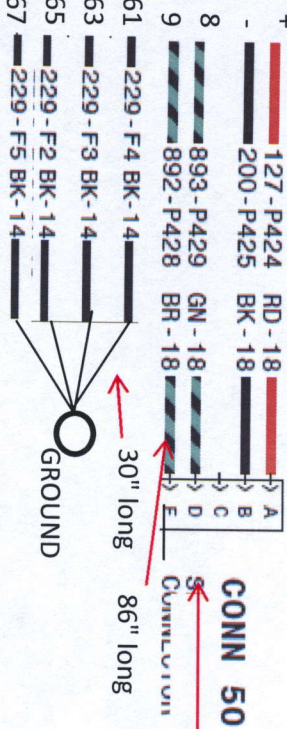
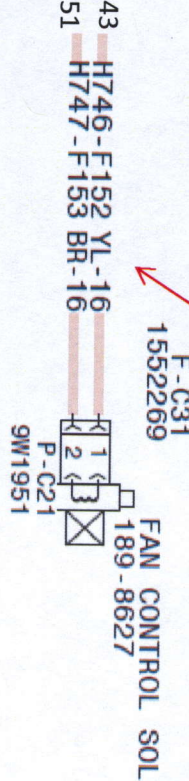
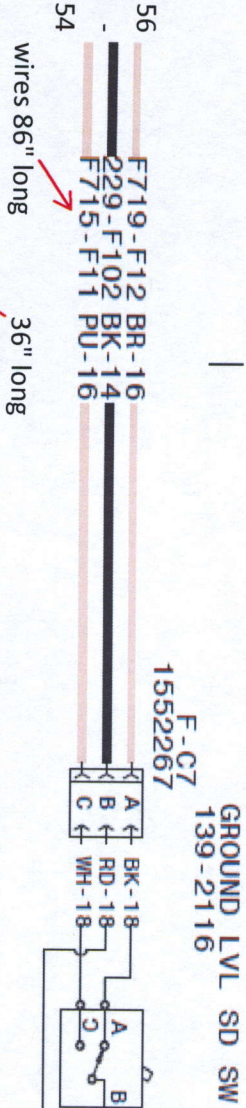
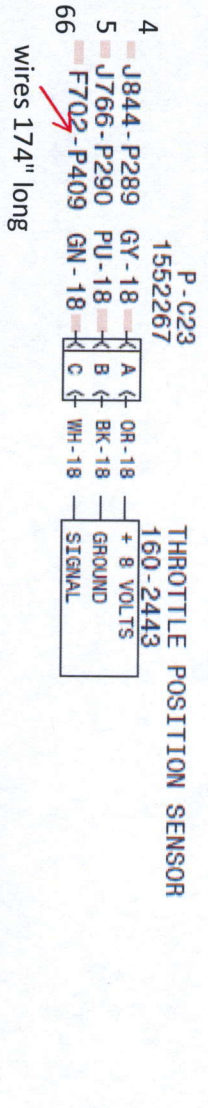

ECM PLUG

